

States Planning Dept
Sir Charles Frossard House
La Charroterie
St P P

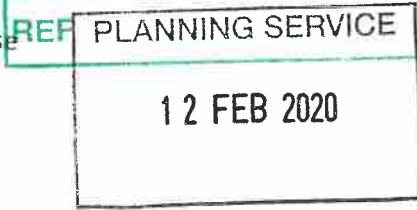

Mr & Mrs E Melrose
Rosewood Cottage
2 Le Petit Frappier
Rue des Marettes
St Martins

Dear Sirs

Enclosed are 4 copies of each digimap showing the area of the proposed development as requested .

Also enclosed map showing the boundary in red, I can confirm this boundary is correct, the house name now is Rosewood Cottage, this has only just recently been changed as a result of the purchase of the property recently.

Also attached are 4 drawings, as requested of the east elevation.

After speaking with various builder, we have been advised that this development may be exempt from planning permission although a building licence will be required, before you register this application can you please check whether it is exempt and if it is reply accordingly, if not please proceed with the application

Kindest Regards



STATES OF GUERNSEY
E - DOCS RECEIVED

12 FEB 2020

REF



Copyright States of Guernsey 2020

Magnolia Cottage
2
Le Petit Frappier
Rue Des Marettes
St. Martin
GUERNSEY
GY4 6JH

Applicants Name :
NB Please indicate any amendments required to the address shown :-

Scale 1:1,250

NB. The details on this plan are illustrative, not defined. The coloured boundary illustrated above does not necessarily indicate the extent of the property or curtilage.

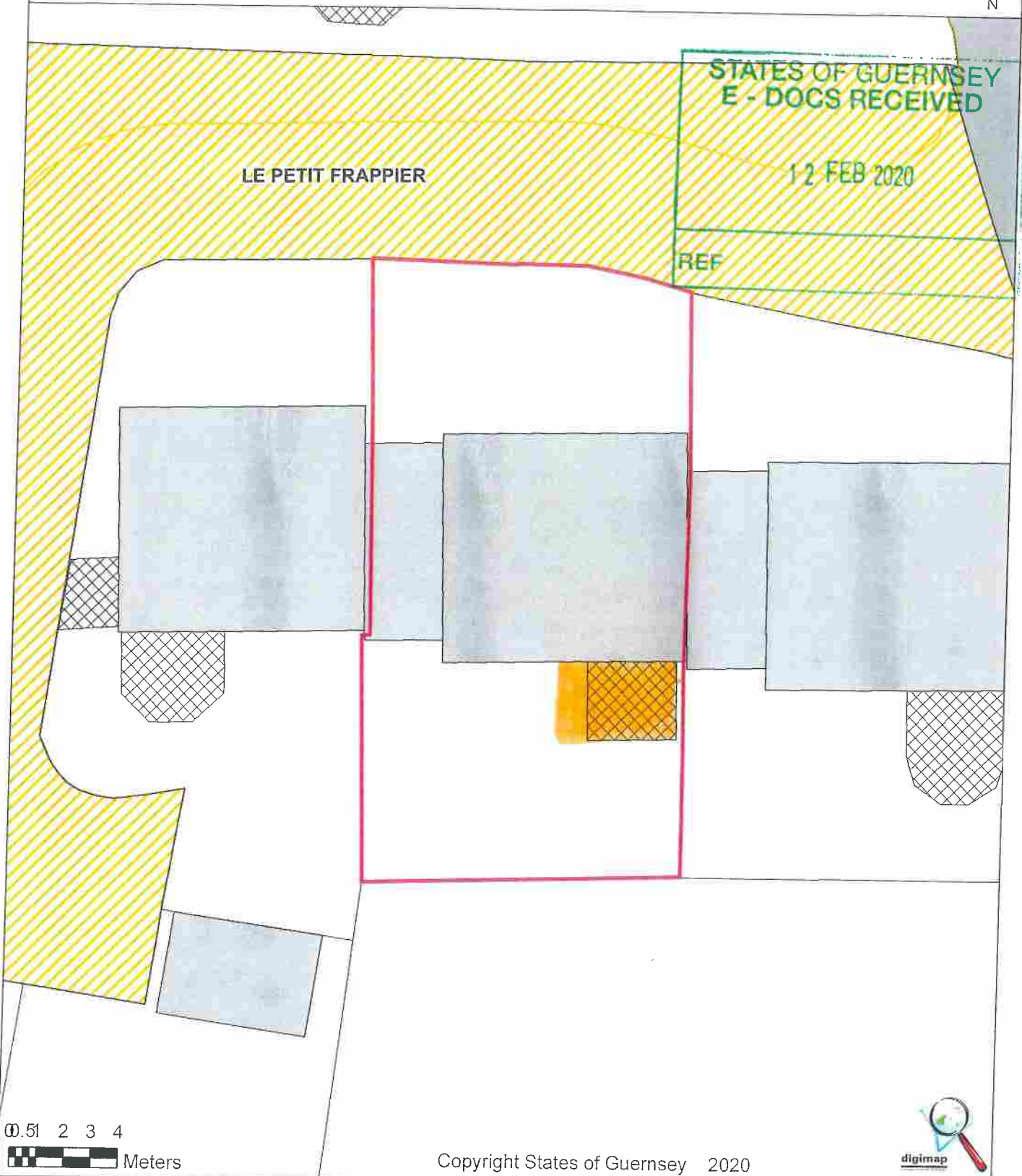

Magnolia Cottage
2
Le Petit Frappier
Rue Des Marettes
St. Martin
GUERNSEY
GY4 6JH

Applicants Name :
NB Please indicate any amendments required to the address shown :-

Scale 1:200

 AREA OF PROPOSED DEVELOPMENT

NB. The details on this plan are illustrative, not defined. The coloured boundary illustrated above does not necessarily indicate the extent of the property or curtilage.

STATES OF GUERNSEY
E - DOCS RECEIVED

12 FEB 2020

REF

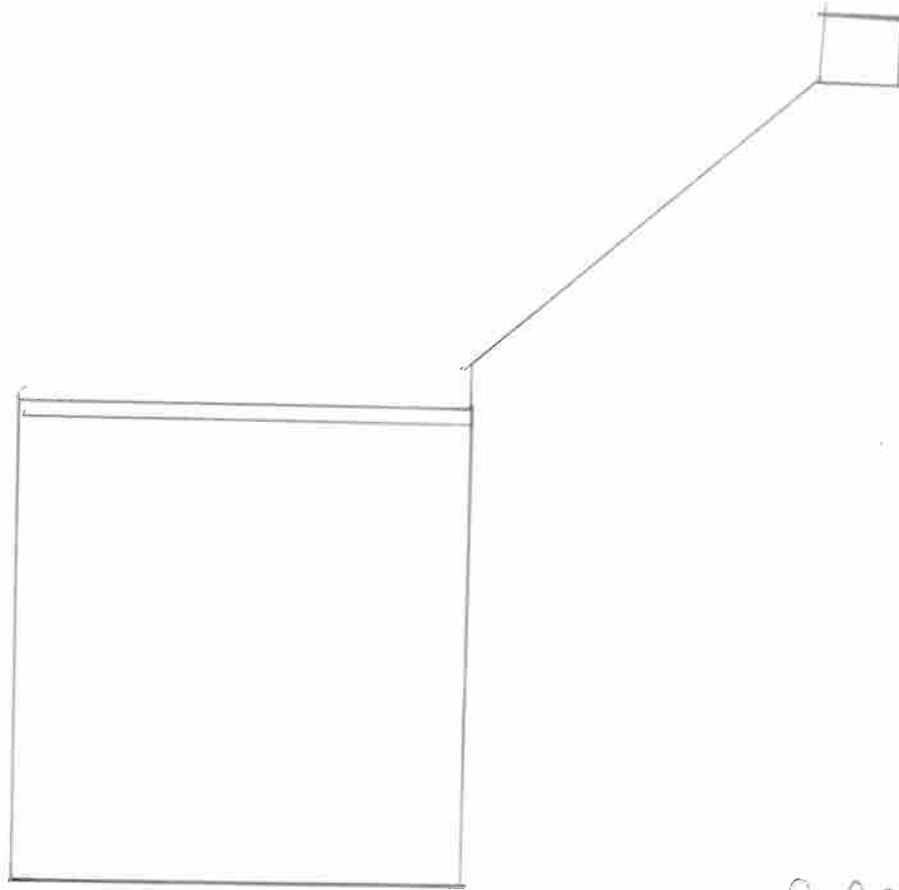

PROPOSED EAST ELEVATION