

**Level +1 First Floor Roof Plan**  
Condenser location  
Scale 1:50

**Level +1 First Floor Plan**  
Scale 1:200

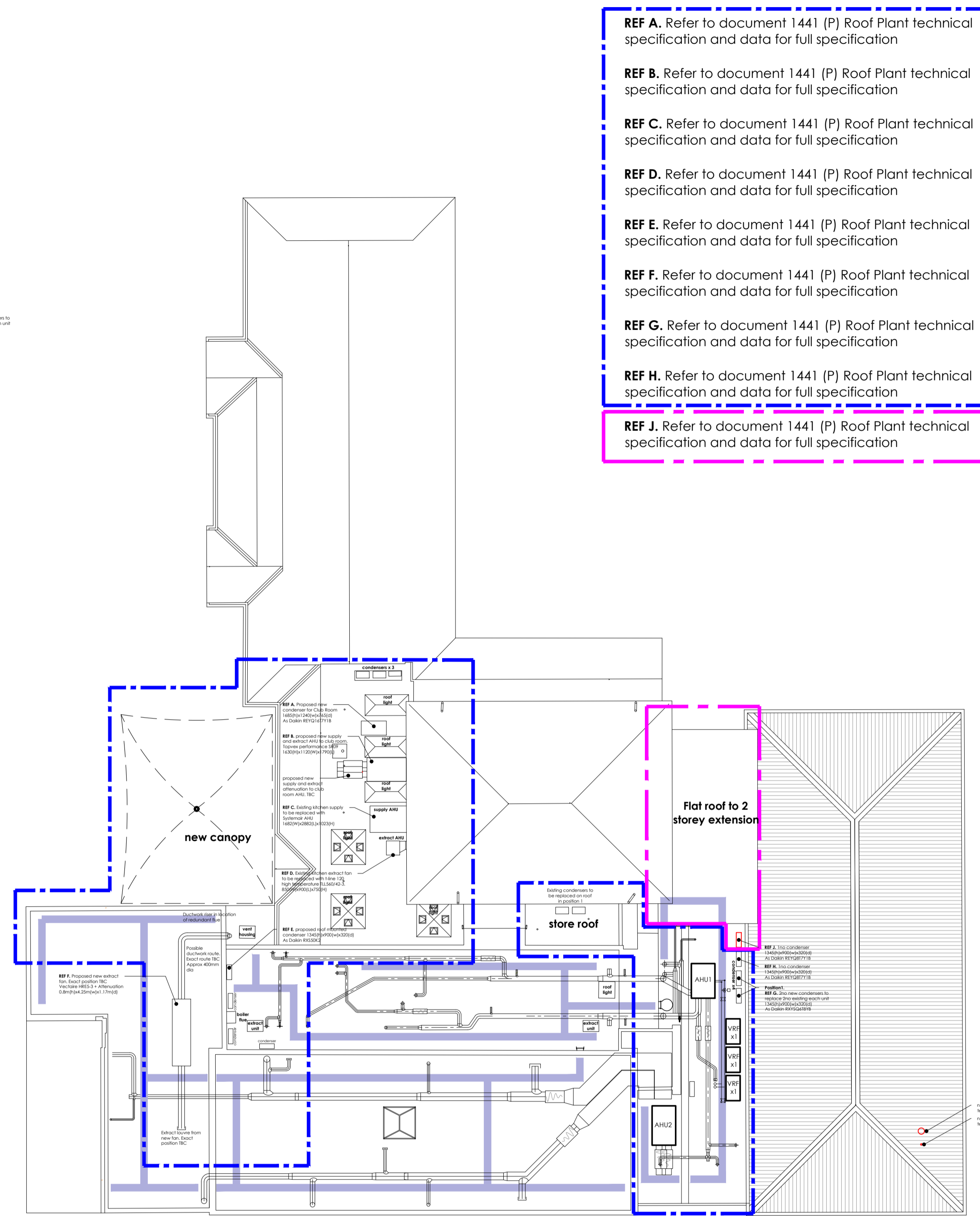

**Level +2 Roof Plan**  
Scale 1:200

- M&E ROOF PLANT REFERENCE KEY**
- REF A.** Refer to document 1441 (P) Roof Plant technical specification and data for full specification
  - REF B.** Refer to document 1441 (P) Roof Plant technical specification and data for full specification
  - REF C.** Refer to document 1441 (P) Roof Plant technical specification and data for full specification
  - REF D.** Refer to document 1441 (P) Roof Plant technical specification and data for full specification
  - REF E.** Refer to document 1441 (P) Roof Plant technical specification and data for full specification
  - REF F.** Refer to document 1441 (P) Roof Plant technical specification and data for full specification
  - REF G.** Refer to document 1441 (P) Roof Plant technical specification and data for full specification
  - REF H.** Refer to document 1441 (P) Roof Plant technical specification and data for full specification
  - REF J.** Refer to document 1441 (P) Roof Plant technical specification and data for full specification

— — — — — Extent of works for previous approved planning application REF - FULL/2019/0816

— — — — — Extent of new application. 2 storey extension

**NORTH**

**GENERAL NOTES**  
This drawing is to be read in conjunction with all related drawings. Do not scale from this drawing. All dimensions must be checked and verified on site before commencing any work or producing shop drawings. The originator should be notified immediately of any discrepancy. This drawing is copyright and remains the property of Garnett Netherwood Architects Ltd.

**SCALE**

REVISIONS	NO	DATE	REVISOR	CHECKED	REVISIONS	NO	DATE	REVISOR	CHECKED
A		2020 03 02							

Updated to suit discussion with Chris Crewe - approved new M&E items now shown in Black

Project	KINGS PREMIER HEALTH CLUB	Scale	1:200 @ A1	Drawn by	JD
	for Kings Property Ltd	Date	29.01.2020	Checked by	NO
Title	2 STOREY EXTENSION - FIRST & ROOF	Drawing Number	1441 (P) 006	Revision	A
	AS PROPOSED				

**GARNETT NETHERWOOD ARCHITECTS**  
46 The Calls, Leeds, LS2 7EY, T: 0113 244 8858 F: 0113 244 8125 www.garnettnetherwood.com