



EVANS
ARCHITECTURE LTD

Evans Architecture Ltd, Vaunac, St Clair Hill,
St Sampson, Guernsey GY2 4DS
Registered No. 65911
tel: 07781 402915
email: silvie@evansarchitecture.gg
web: evansarchitecture.gg



Notes

This document and its design content is copyright ©. It shall be read in conjunction with all other associated project information including models, specifications, schedules and related consultants documents. Do not scale from documents. All dimensions to be checked on site. Immediately report any discrepancies, errors or omissions on this document to the Originator. If in doubt ASK.

In addition to the hazard/risks normally associated with the types of work detailed on this drawing take note of the above. It is assumed that all works on this drawing will be carried out by a competent contractor working, where appropriate, to an appropriate method statement.

Revision	Description	Date

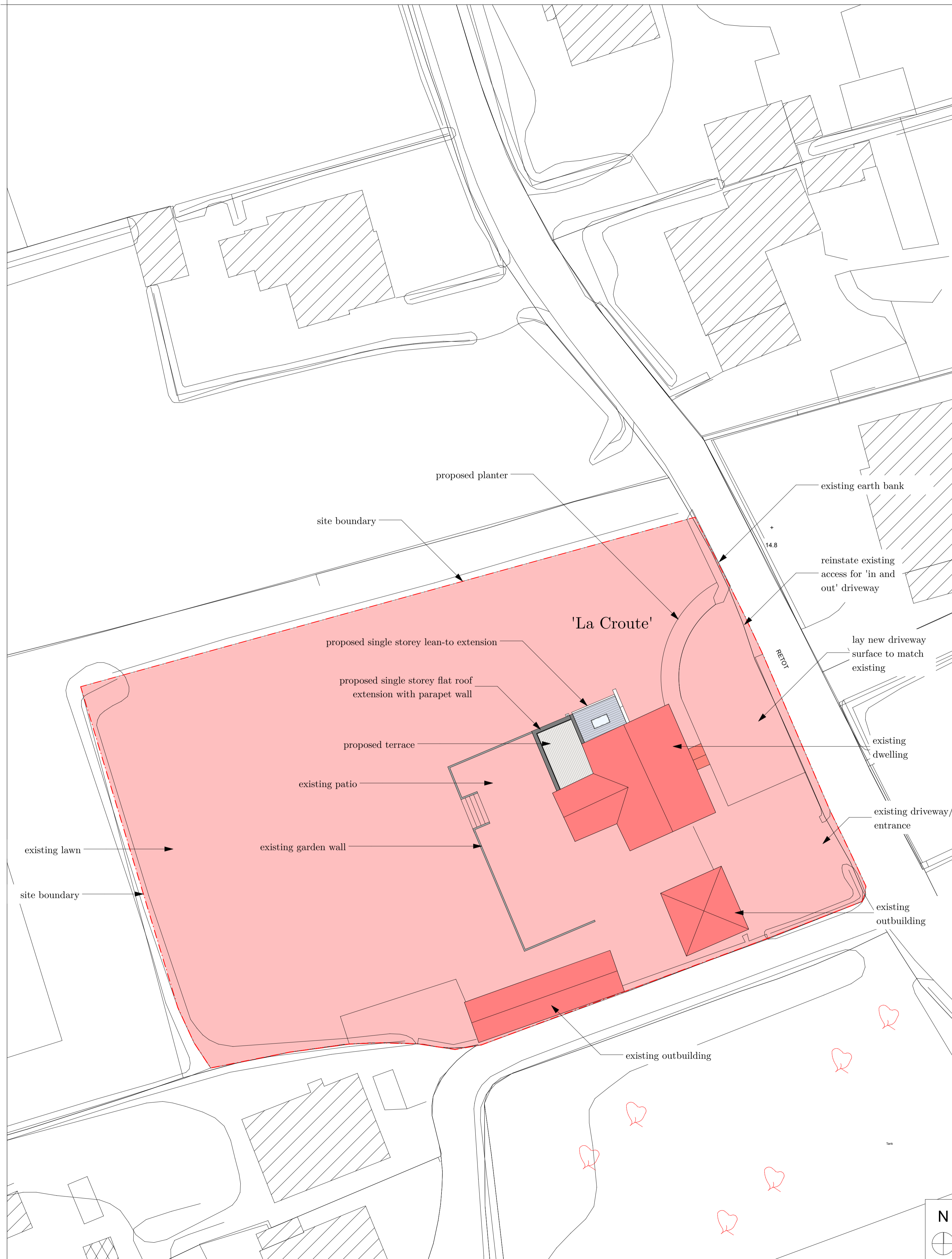

Block Plan

1:200

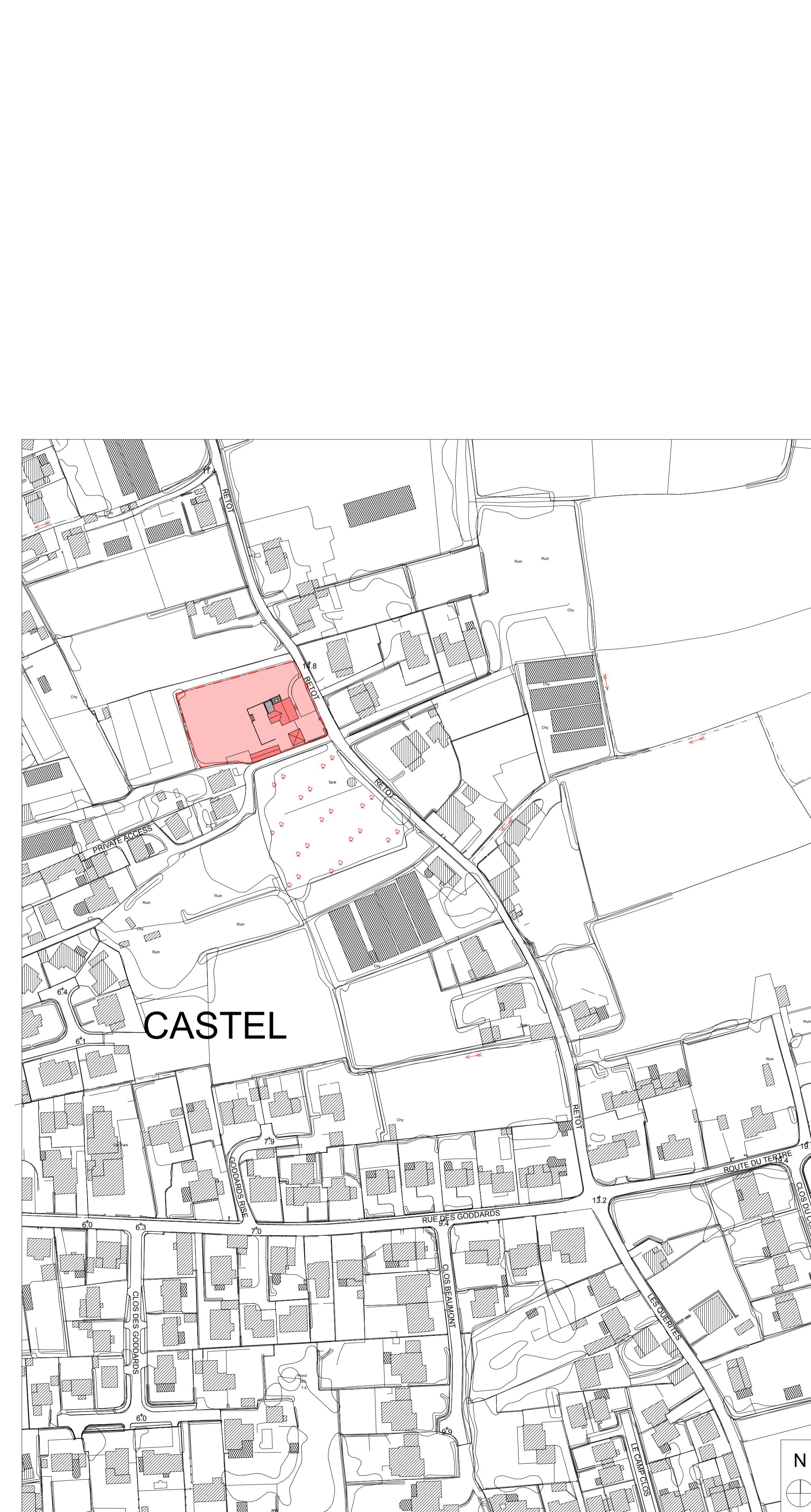

Location Plan

1:1250

Project
Proposed Extension and Alterations
at;
La Croute
Retot Lane
Castel
Guernsey
GY5 7EG

Client
Mr and Mrs G. Robilliard
La Croute
Castel
Guernsey
GY5 7EG

Layout Title
Block and Location Plan

Scales @ A1	Project No.	Drawing No.	Date
as noted	2006	01.01	27/02/20