

NOTES

THE CONTRACTOR & HIS SUB-CONTRACTORS ARE TO VERIFY ALL DIMENSIONS ON SITE BEFORE MAKING SHOP DRAWINGS OR COMMENCING MANUFACTURE.

THE CONTRACTOR & HIS SUB-CONTRACTORS ARE RESPONSIBLE FOR ENSURING THAT ALL PRODUCTS AND MATERIALS ARE INSTALLED CORRECTLY IN ACCORDANCE WITH MANUFACTURERS DETAILS, CURRENT BRITISH STANDARDS AND CODES OF PRACTICE.

ANY DISCREPANCIES OR CONFUSION ARISING FROM INFORMATION PROVIDED IS TO BE REPORTED TO THE ARCHITECT PRIOR TO WORKS COMMENCING.

THIS DRAWING IS COPYRIGHT

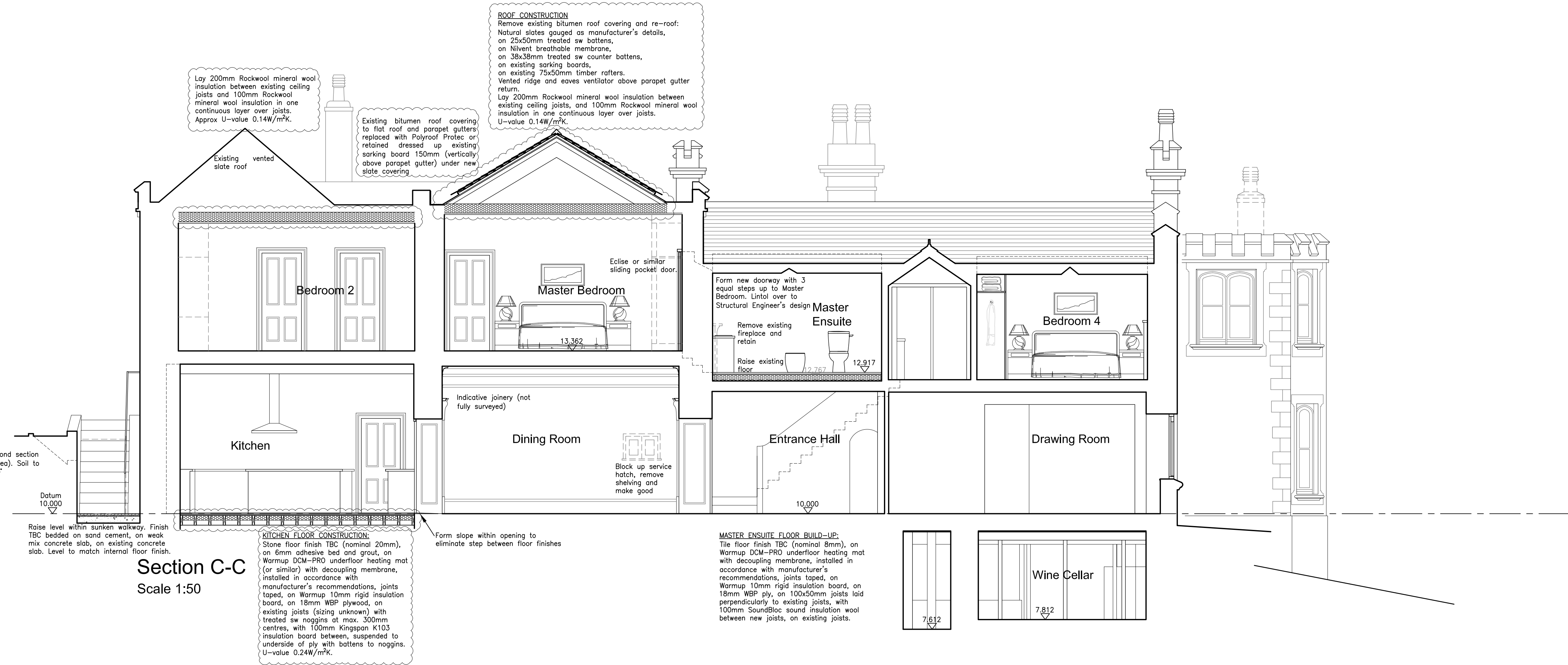

Section C-C
Scale 1:50

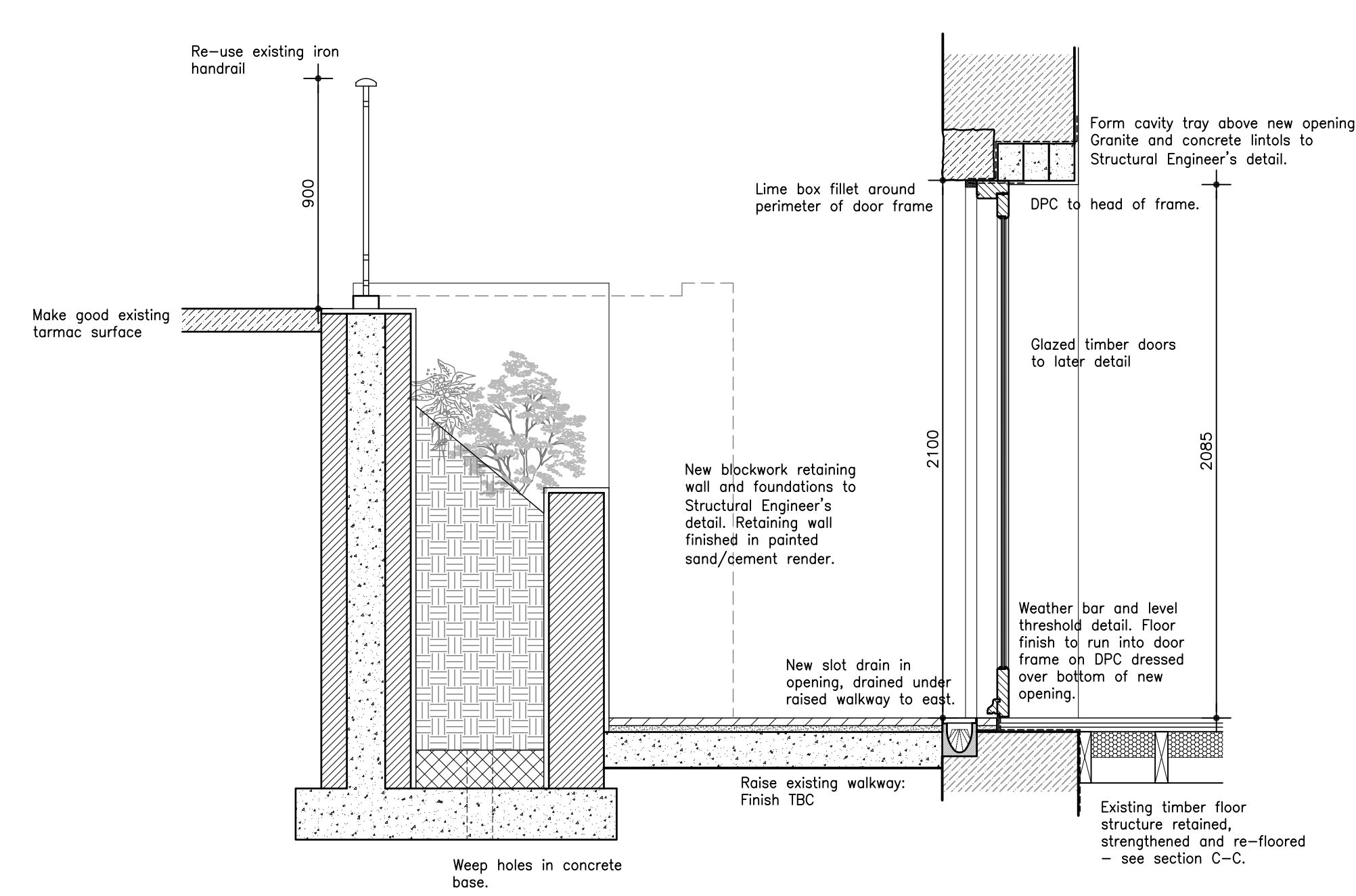

Part Section E-E
Scale 1:20

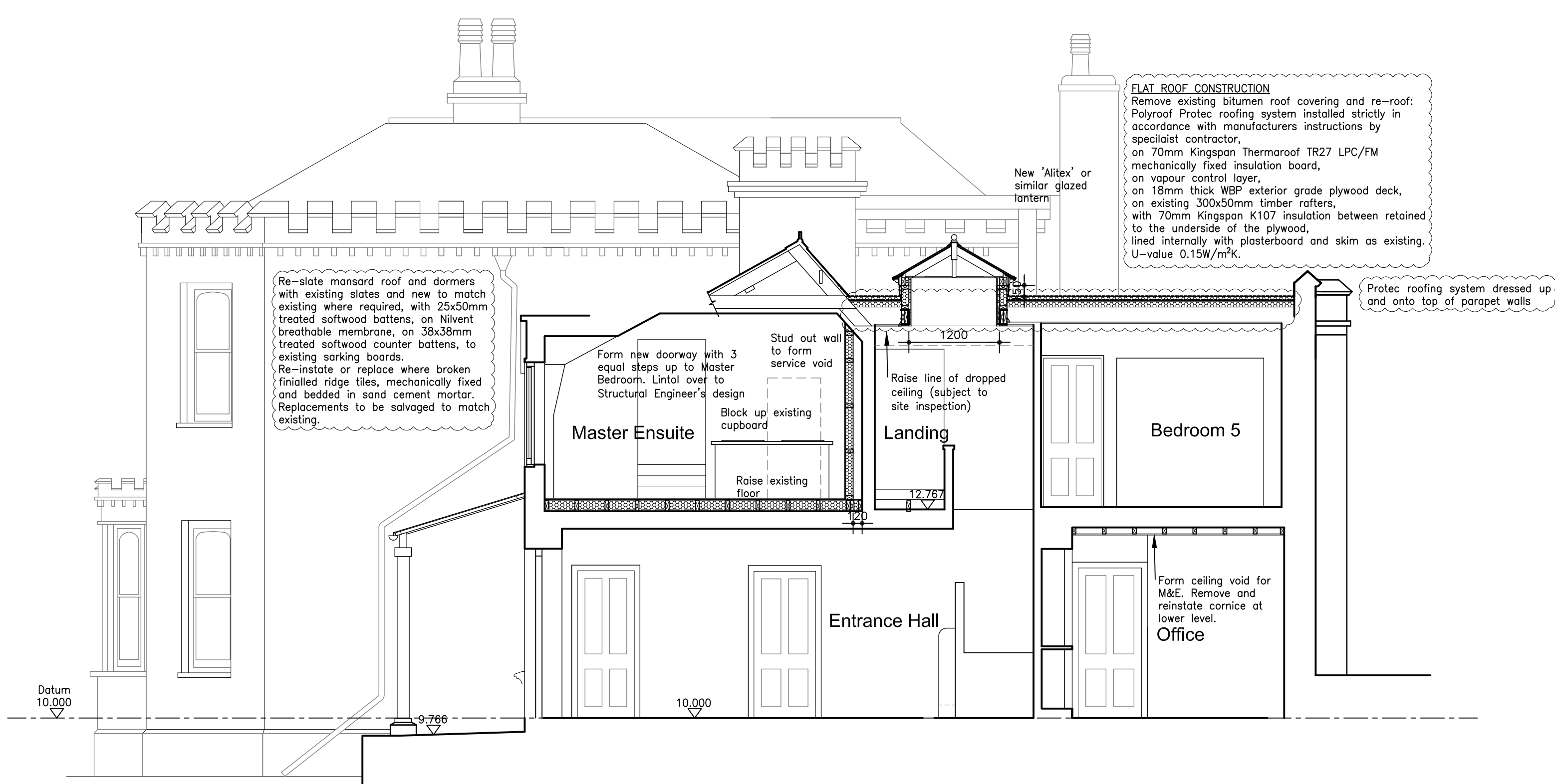

Section D-D
Scale 1:50

Rev. C, Revised Planning Application. - R.L. - 04.03.20
Rev. B, Planning Minor Amendments. - R.L. - 27.02.20
Rev. A, Alterations to M&E layouts. - R.L. - 14.11.19

Proposed alterations to:
Ferremina
Ferremin Lane
St Martin
for Mr and Mrs P. Briginshaw
WORKING DRAWING

Section C-C, D-D & E-E



Chartered Architects & Interior Designers
Trafalgar House, Petit Bouet, St. Peter Port
Guernsey Channel Islands GY1 2AY
Tel: (01481) 724461
E-mail: mail@ccd-architects.com Web: www.ccd-architects.com

Scale:	1:50 @ A1	Date:	September 2019
Job No:	3530	Drng No:	WD/03
A	B	C	