



PHOTO 1

BLOCK PLAN 1:1000

PHOTO 4



PHOTO 2



PHOTO 5



PHOTO 3



PHOTO 6

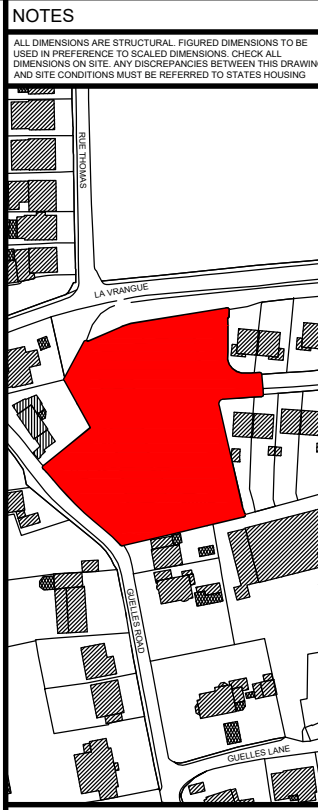

NOTES

ALL DIMENSIONS ARE STRUCTURAL. FIGURED DIMENSIONS TO BE USED IN PREFERENCE TO SCALED DIMENSIONS. CHECK ALL DIMENSIONS ON SITE. ANY DISCREPANCIES BETWEEN THIS DRAWING AND SITE CONDITIONS MUST BE REFERRED TO STATES HOUSING

General Notes:

1. Existing timber windows and doors are to be replaced with Upvc units, to match existing in size and style.
2. The replacement will be phased as properties are vacated and to undergo maintenance.
3. All units to be installed in accordance with manufacturers recommendations, once supplier has been chosen, following tender process.
4. All works are to be carried out in accordance with the Guernsey Building Regulations and adhere to all specific Guernsey Technical Standards.

States Housing  
PROPERTY MANAGEMENT

Edward T. Wheadon House, Le Truchot, St. Peter Port, GY1 3WH  
Tel: 01481 713465 email: housing.maintenance@gov.gg

PROJECT  
Replacement Windows & Doors:  
La Guelle Flats,  
La Vrangue,  
St. Peter Port.

TITLE  
Location & Block Plans.

JOB NUMBER	DRAWING NUMBER
0025	002

DRAWN BY	SCALE	DATE
MTB	As Stated At A3	16/02/20