

**DIMENSIONS**  
ALL DIMENSIONS WHERE APPLICABLE TO BE CHECKED ON SITE PRIOR TO WORKS COMMENCING

REVISION			
REV.	DATE	DESCRIPTION	SIG.

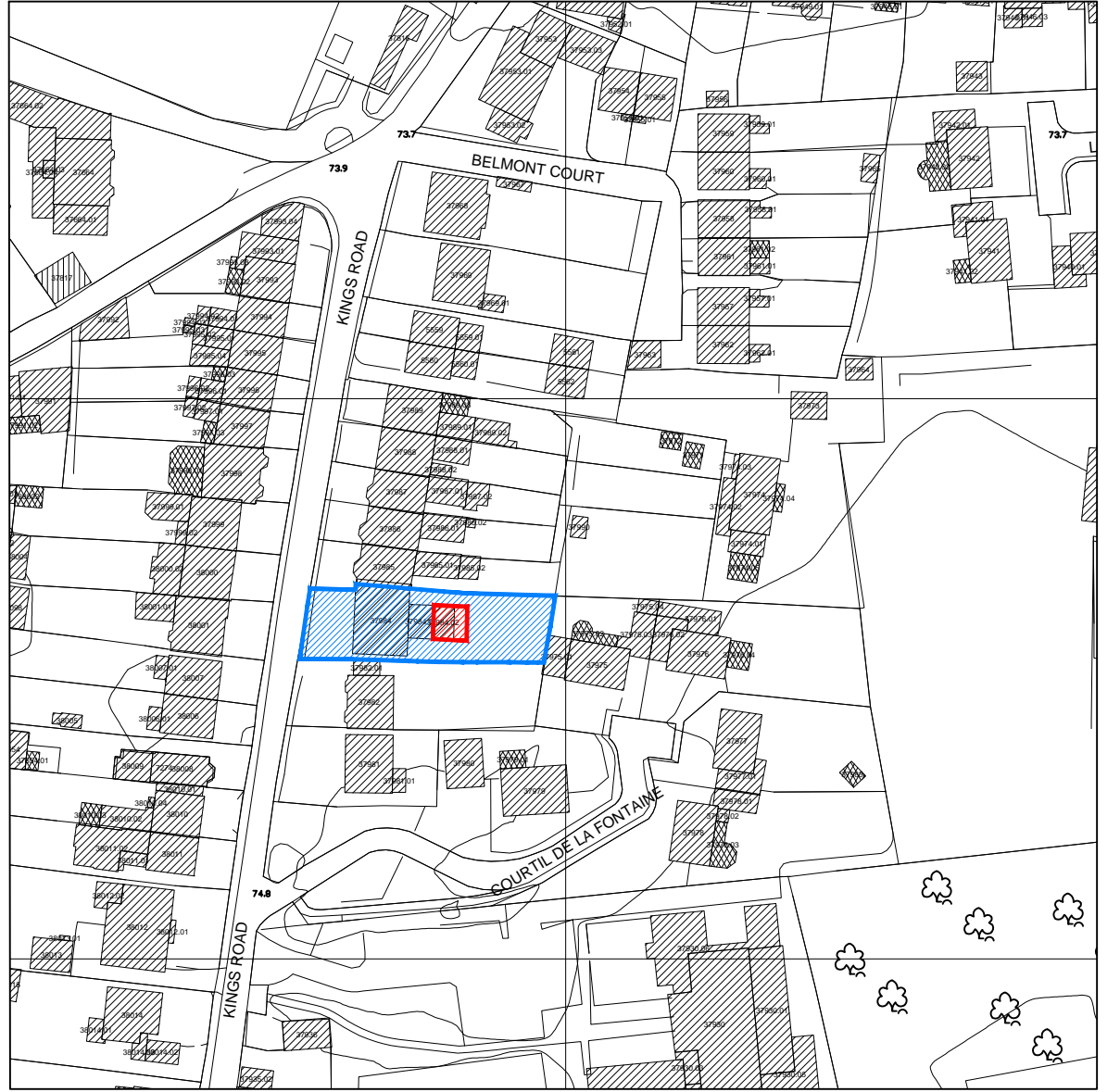

**Location Plan** Scale 1:1250  
Copyright 2008 States of Guernsey/Digimap Ltd  
Digimap Licence No. 121

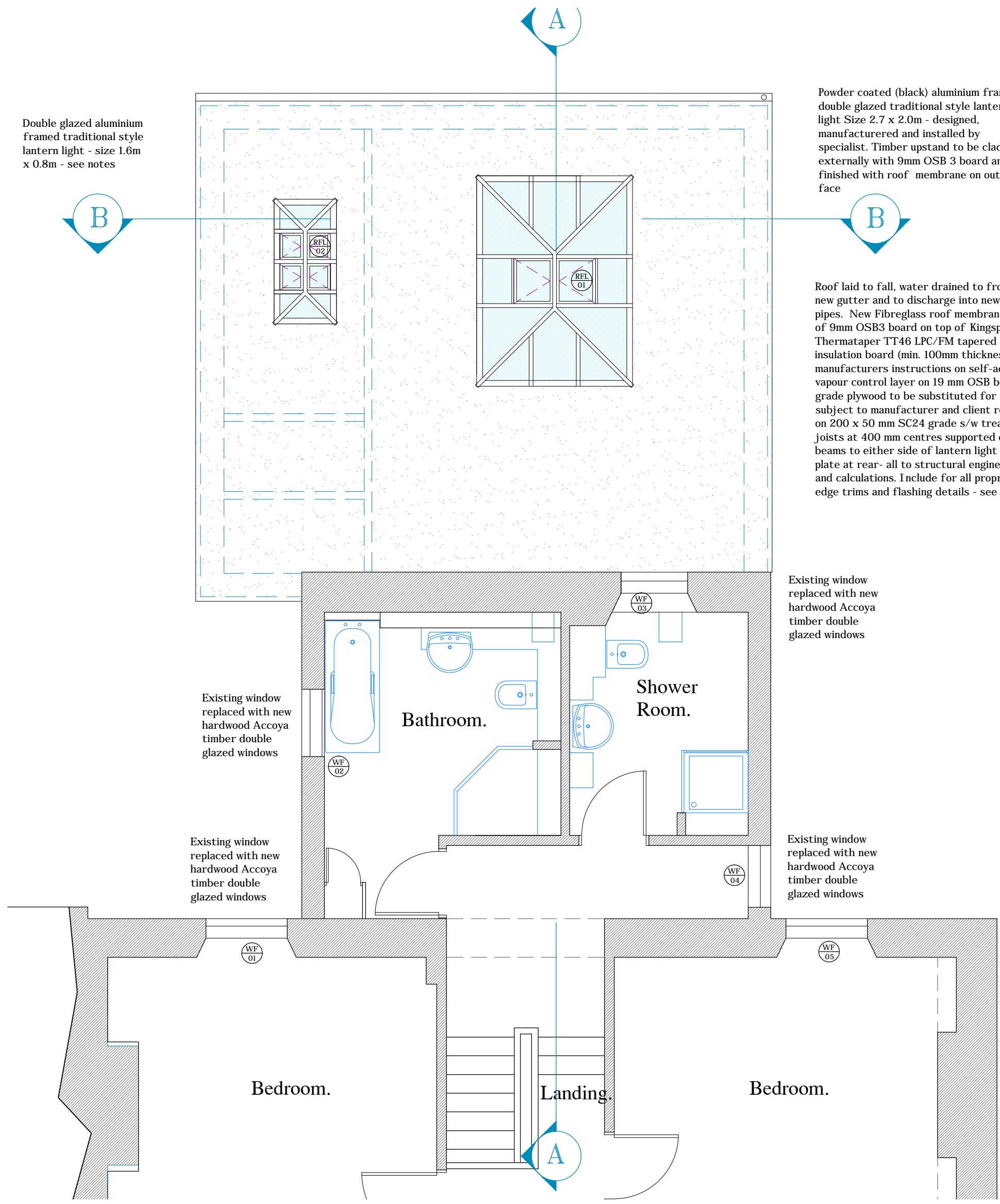
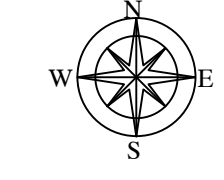

**Part First Floor Plan.**  
Scale - 1:50.

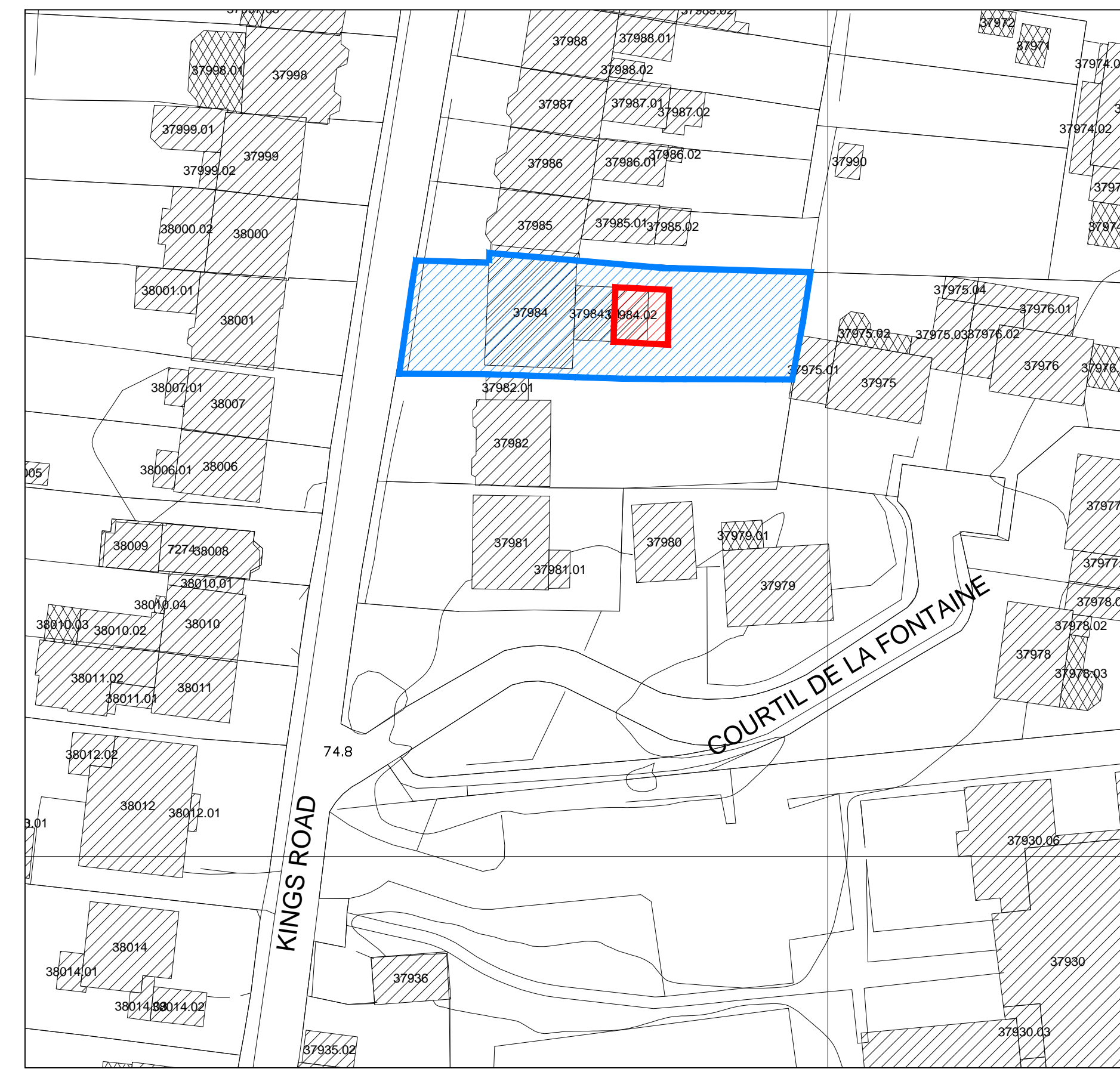

**Block Plan**  
Scale - 1:500.

NOTE: Existing drainage information taken from DrainForce survey supplied by client.

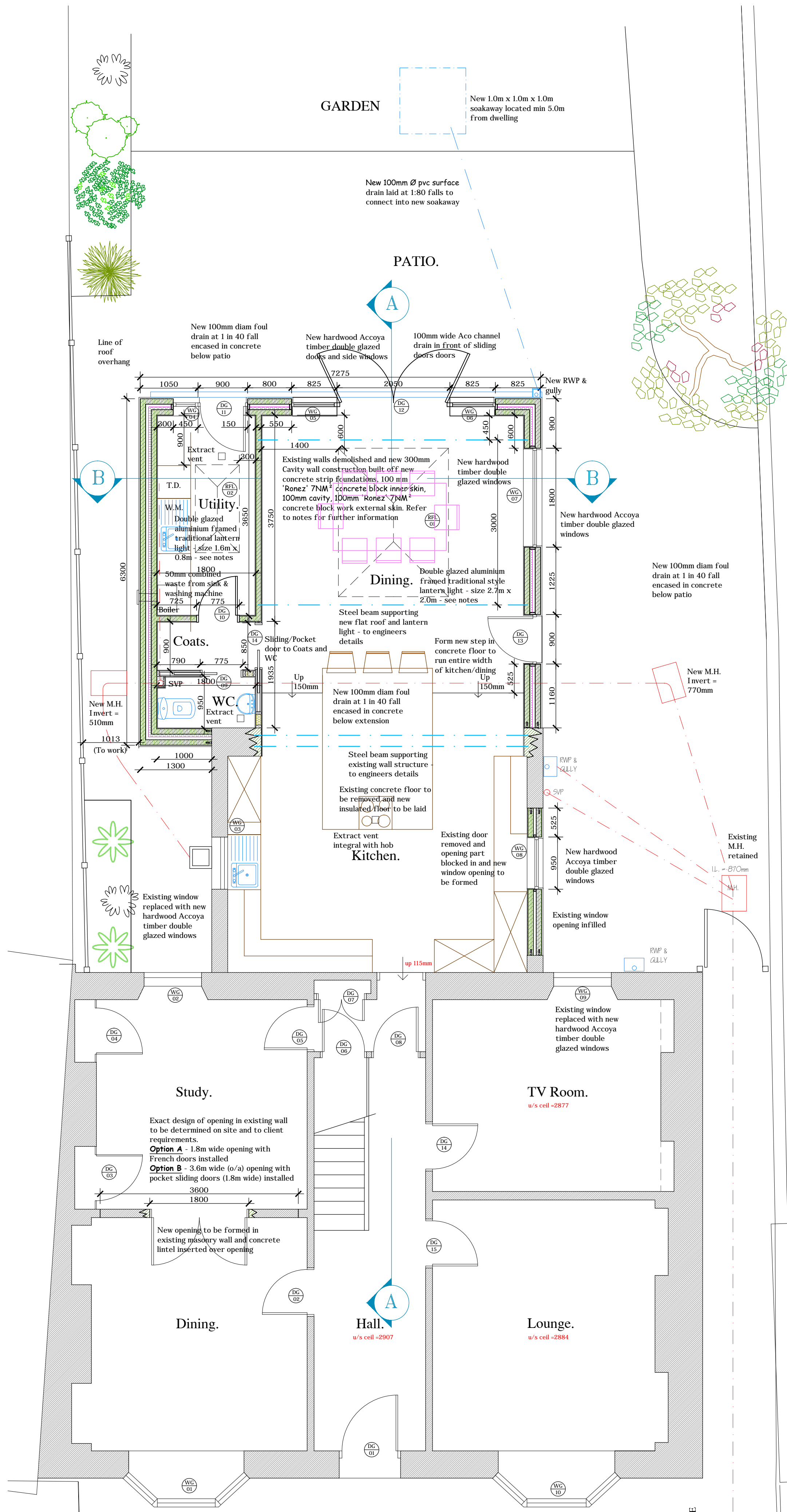

**Ground Floor Plan /Part Site Plan.**  
Scale - 1:50.

This drawing is to be read in-conjunction with drawing No's: 1394-WD-02, 03, 04 & 05

**DIRECT ARCHITECTURAL SOLUTIONS**  
CHARTERED SURVEYOR - ARCHITECTURAL TECHNOLOGIST - PROJECT MANAGEMENT  
CLOS DU GAINS, RUE DU GAINS, TEL - OFFICE +44 (0)1481 266311.  
ST PETERS, GUERNSEY, GY7. FAXSIMILE +44 (0)1481 266322.

PROJECT	Extension and Alterations to Existing Dwelling at St Brendans, Kings Road, St Peter Port, Guernsey.		
CLIENT	Mr. & Mrs. C. Waldron.		
DRAWING	Working Drawing - Ground & First Floor Plans		
SCALE	1:50	DRAWN	Carl and JB.
		DATE	9th December 2019
DRAWING NO.	1394-WD-01.		REVISION