

**SOUTH ELEVATION**

SCALE 1:50

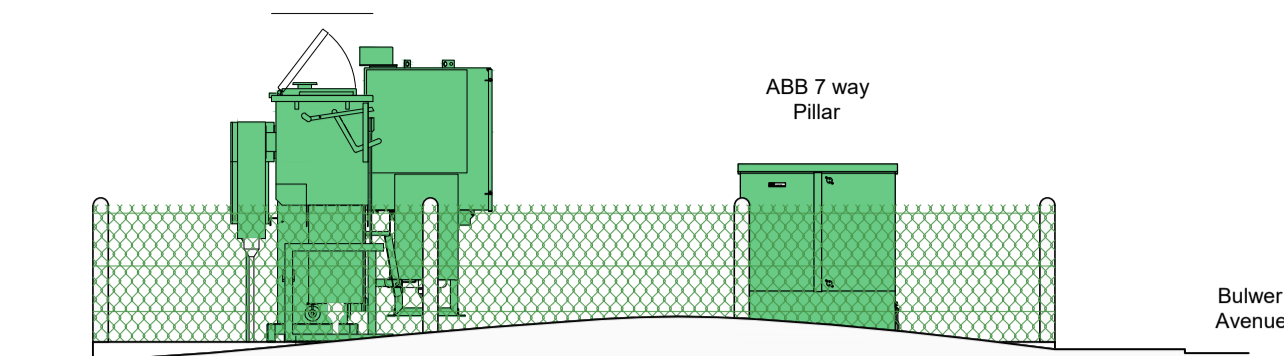

**WEST ELEVATION**

SCALE 1:50

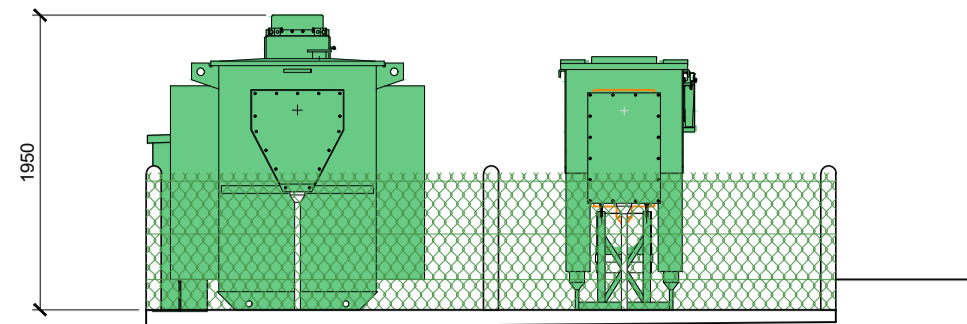

**NORTH ELEVATION**

SCALE 1:50

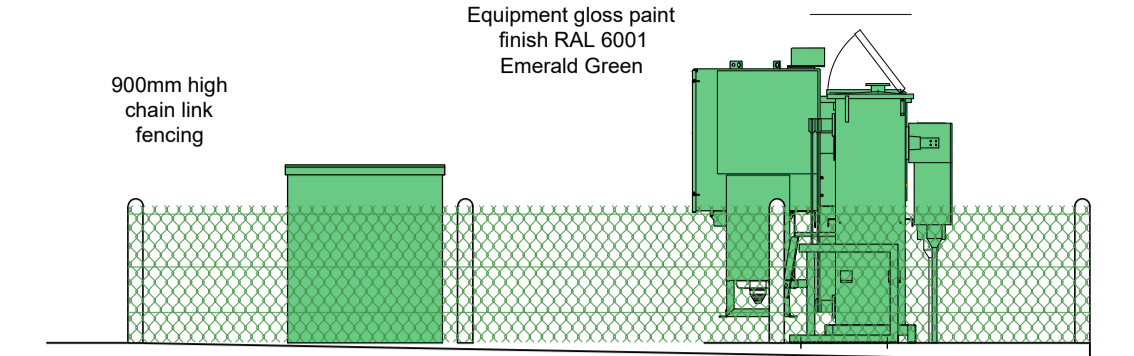

**EAST ELEVATION**

SCALE 1:50

**EXISTING ELEVATIONS**

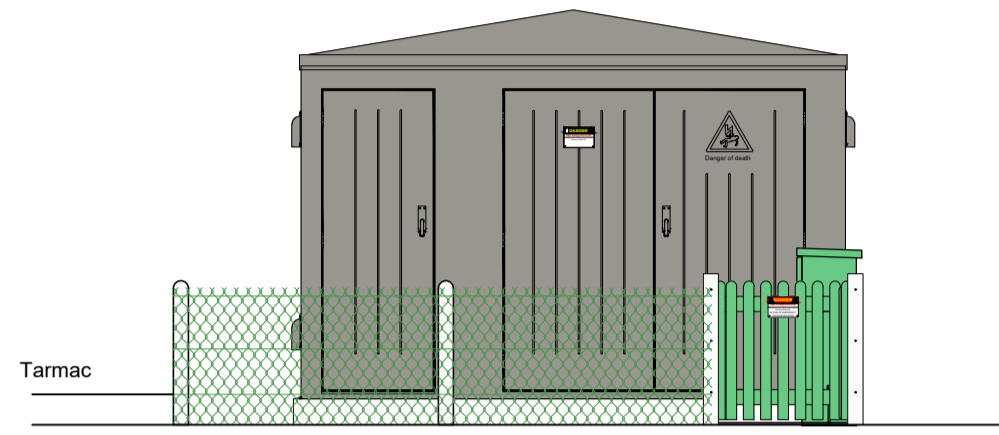

**SOUTH ELEVATION**

SCALE 1:50

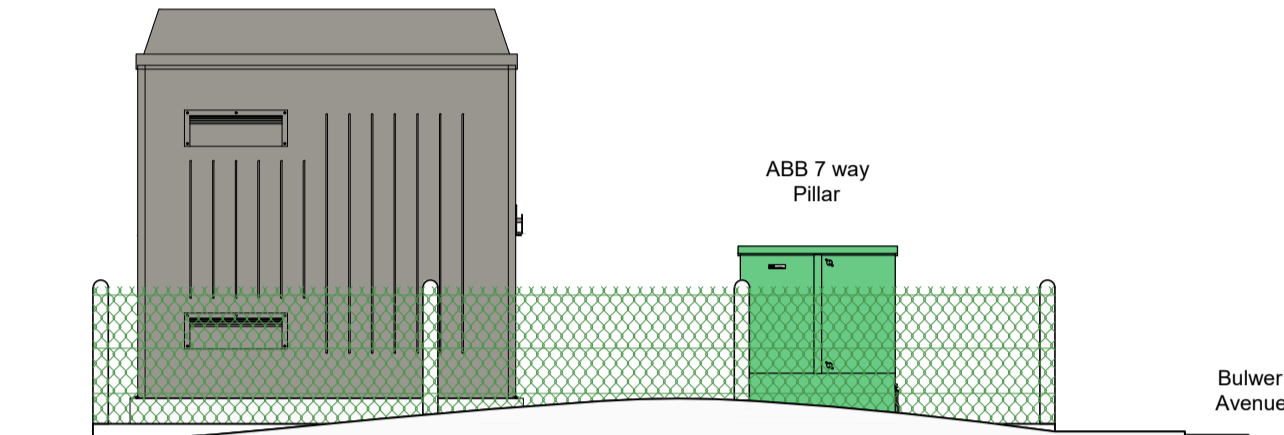

**WEST ELEVATION**

SCALE 1:50

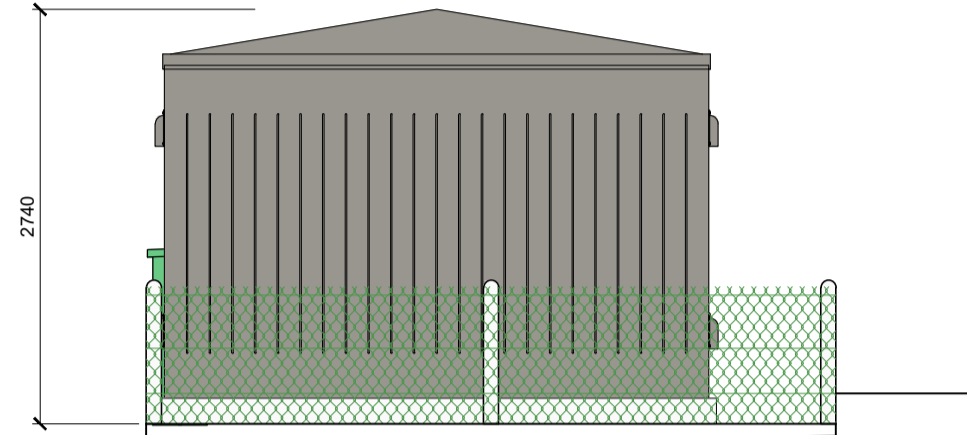

**NORTH ELEVATION**

SCALE 1:50

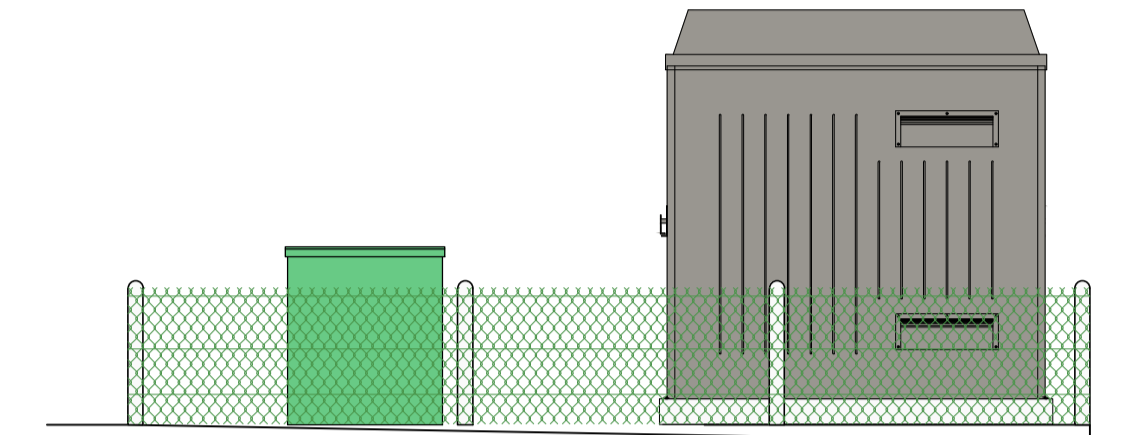

**EAST ELEVATION**

SCALE 1:50

**PROPOSED ELEVATIONS**

Island Development Plan 2016

GP9: Sustainable Development

This information note has been prepared in support of our Planning Application for the bunding & GRP Housing of the Existing Electricity distribution substation constructed circa 2008

The proposed scheme considers various strategic and legislative parameters as covered in the attached supporting documentation provided separately.

The proposal makes full use of existing site and provides a better and modern solution to what is currently provided.

Maintenance at the site will be undertaken with technicians parking on site with agreement of the land owner. Guernsey Electricity has reviewed the network and aerial photography, & concluded there are no viable alternative locations for this asset. The proposed scheme provides a safe and secure working area for our engineers.

The materials proposed in this scheme have been carefully chosen to provide the necessary safety and security as outlined in the attached supporting documentation.

GP17: Public Safety & Hazardous Development

It is proposed to secure the perimeter of the Guernsey Electricity Ltd electrical distribution equipment within an industry specific GRP enclosure, preventing unauthorised access and providing necessary environmental and security measures.

IP11: small-scale infrastructure provision

The proposal protects the existing electrical distribution equipment dating from the 2008, enhances the existing oil bunding provision, while upgrading the site security & public safety to pass present regulatory requirements by enclosing the site within a GRP Housing.

**NOTES**

**Site Security:**  
Envico Engineering Ltd 3.600m x 2.500m TR17 GRP Transformer housing with 1 set of double front doors & a single front door, & a total of 4 nos air vents finished white internally & semi gloss finish in (BS4800) 10 A 07 Hurricane Grey externally

**Electrical equipment finish:** Gloss paint on primer Standard Guernsey Electricity finish Emerald Green (RAL 6001)

**Bunding:**  
Designed for the maximum of a 1mVA TX

140x215x440 standard blocks on flat with 20mm water proof render with plastic angle bead edges, & two coats of Grace Betec flexible cementitious liner, laid to Manufacturers instructions

CG Power 1mVA Unit TX,  
905 litres of oil x 110% = 1.007m<sup>3</sup> to bund

GRP Enclosed site with rendered bund wall = 1.242m<sup>3</sup>

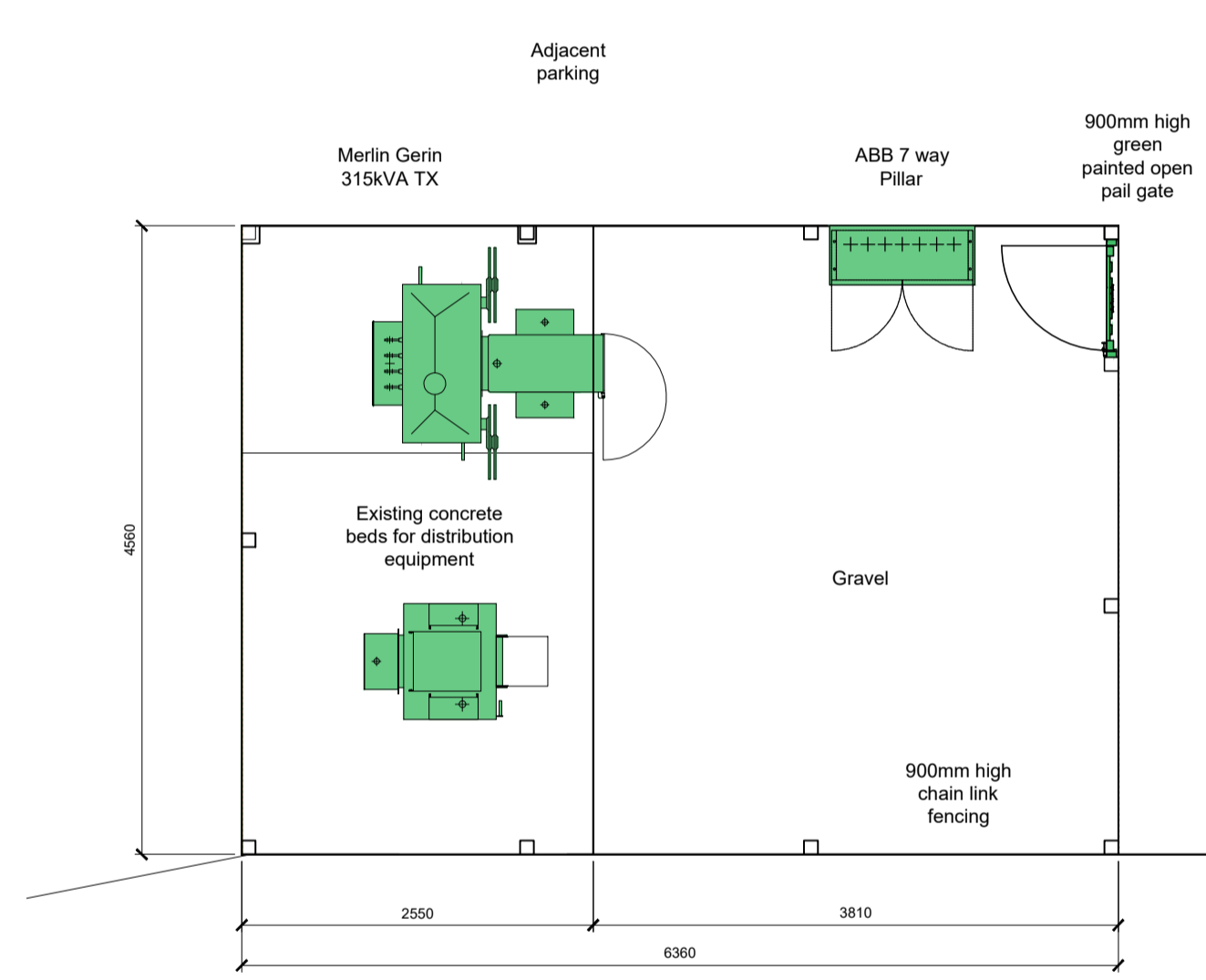

**EXISTING PLAN**

SCALE 1:50

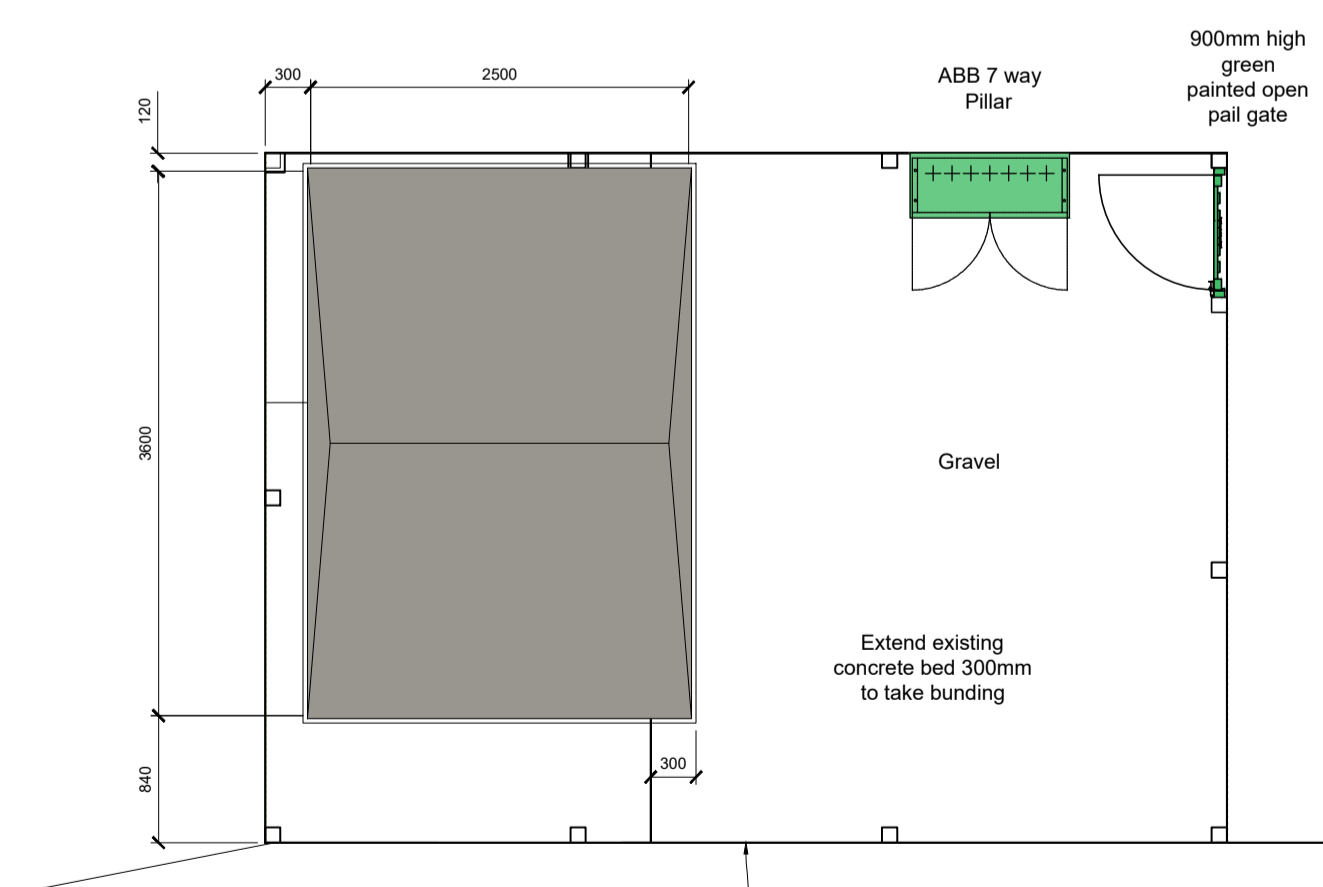

**PROPOSED PLAN**

SCALE 1:50

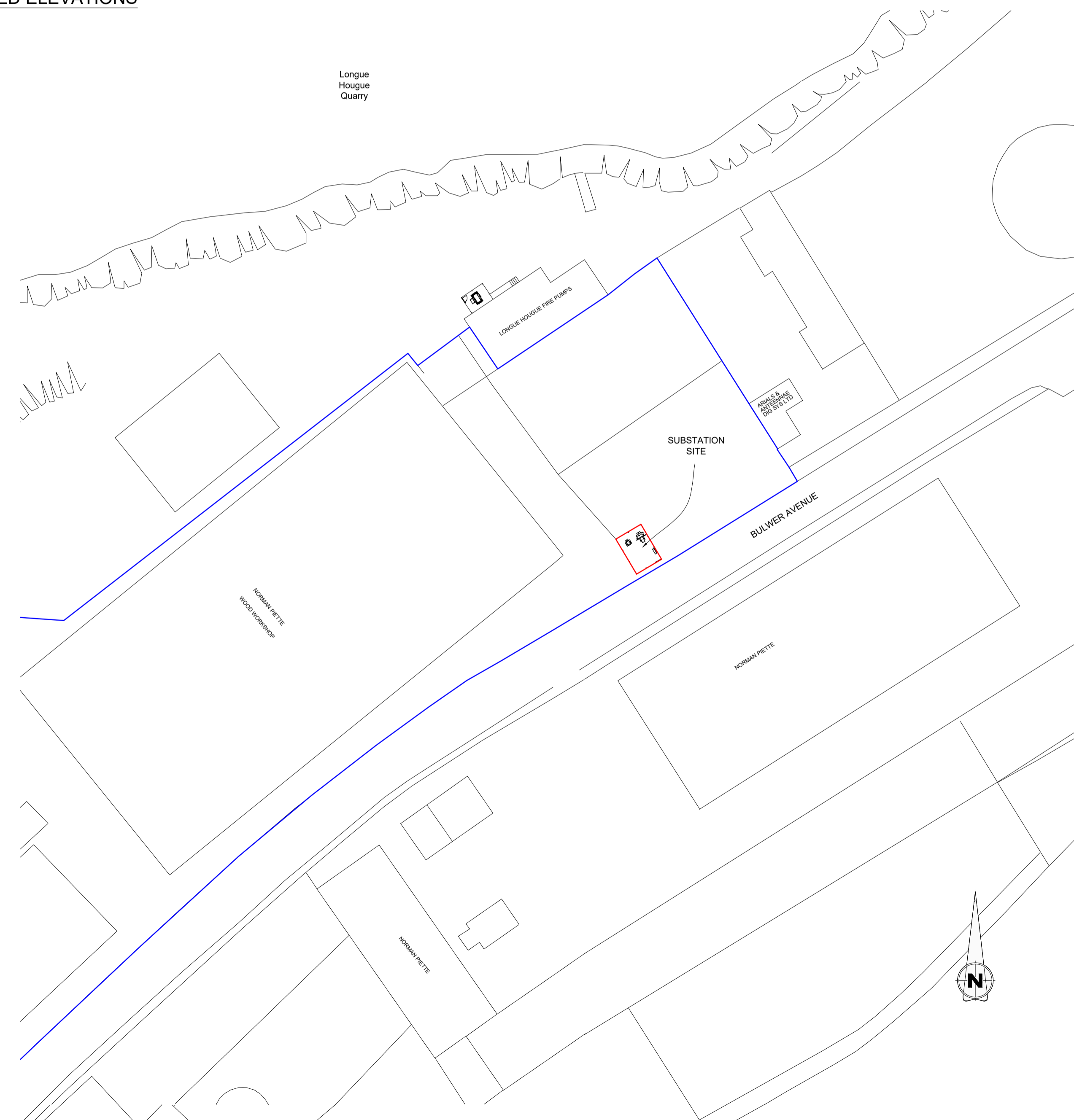

**SITE PLAN**

SCALE 1:500

**IF IN DOUBT ASK**

THIS DRAWING IS THE COPYRIGHT OF GUERNSEY ELECTRICITY LTD  
FIGURED DIMENSIONS TAKE PRECEDENCE OVER SCALED DIMENSIONS  
ALL DIMENSIONS TO BE CHECKED ON SITE AND ANY DISCREPANCIES ARE TO BE REPORTED IMMEDIATELY TO THE ENGINEER  
DETAIL AND LARGER SCALE DRAWINGS TAKE PRECEDENCE OVER SMALLER SCALE DRAWINGS

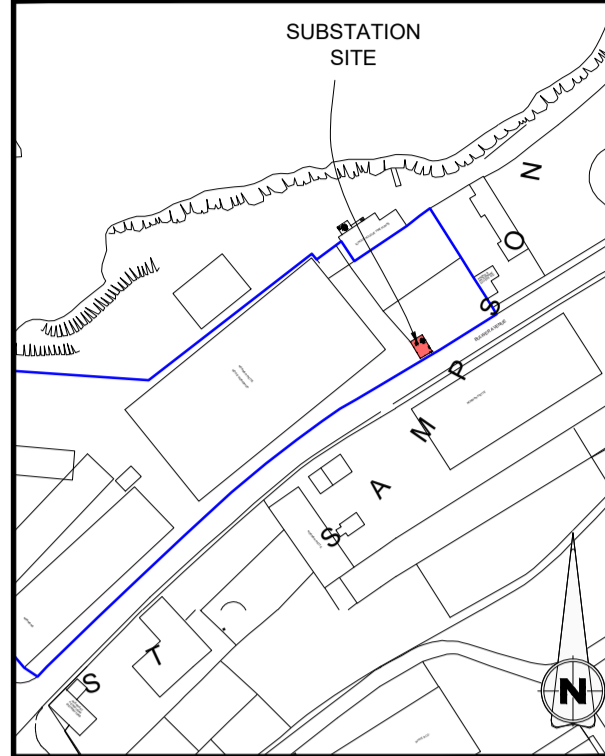

**LOCATION PLAN**

SCALE 1:2500

REV	DATE	DESCRIPTION	INT	APP
		This is a controlled maintained document. All copies printed, photocopied or via the internet will be deemed uncontrolled.		
		Drawing Status		<b>APPROVED</b>
		Discipline		<b>PLANNING</b>

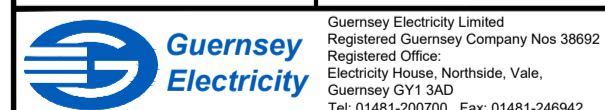

**LONGUE HOUQUE SUBSTATION**  
BULWER AVENUE,  
ST. SAMPSON, GUERNSEY

**BUND & ENCLOSE EXISTING SUBSTATION:**  
PLANNING PROPOSAL  
PLANS & ELEVATIONS

Author	RB	Check	RB 02/12/2019	Issue	PLT 21/02/2020
--------	----	-------	---------------	-------	----------------

09-0238 | P016655- D04 | -