

COPYRIGHT
THE COPYRIGHT OF THIS DRAWING IS THE PROPERTY OF THE ARCHITECTS AND MAY NOT BE REPRODUCED WITHOUT THEIR PERMISSION.

NOTES
FIGURED DIMENSIONS TO BE USED IN PREFERENCE TO SCALED DIMENSIONS. CONTRACTORS MUST CHECK ALL DIMENSIONS ON SITE. ANY DISCREPANCIES BETWEEN THIS DRAWING AND SITE CONDITIONS MUST BE REFERRED TO THE ARCHITECTS IMMEDIATELY.

AMENDMENTS
A Fenestration amended 2-7-20
B
C

ALL ORIGINAL LAYOUTS TAKEN FROM ARCHIVE DRAWINGS AND ARE SUBJECT TO ON-SITE VERIFICATION

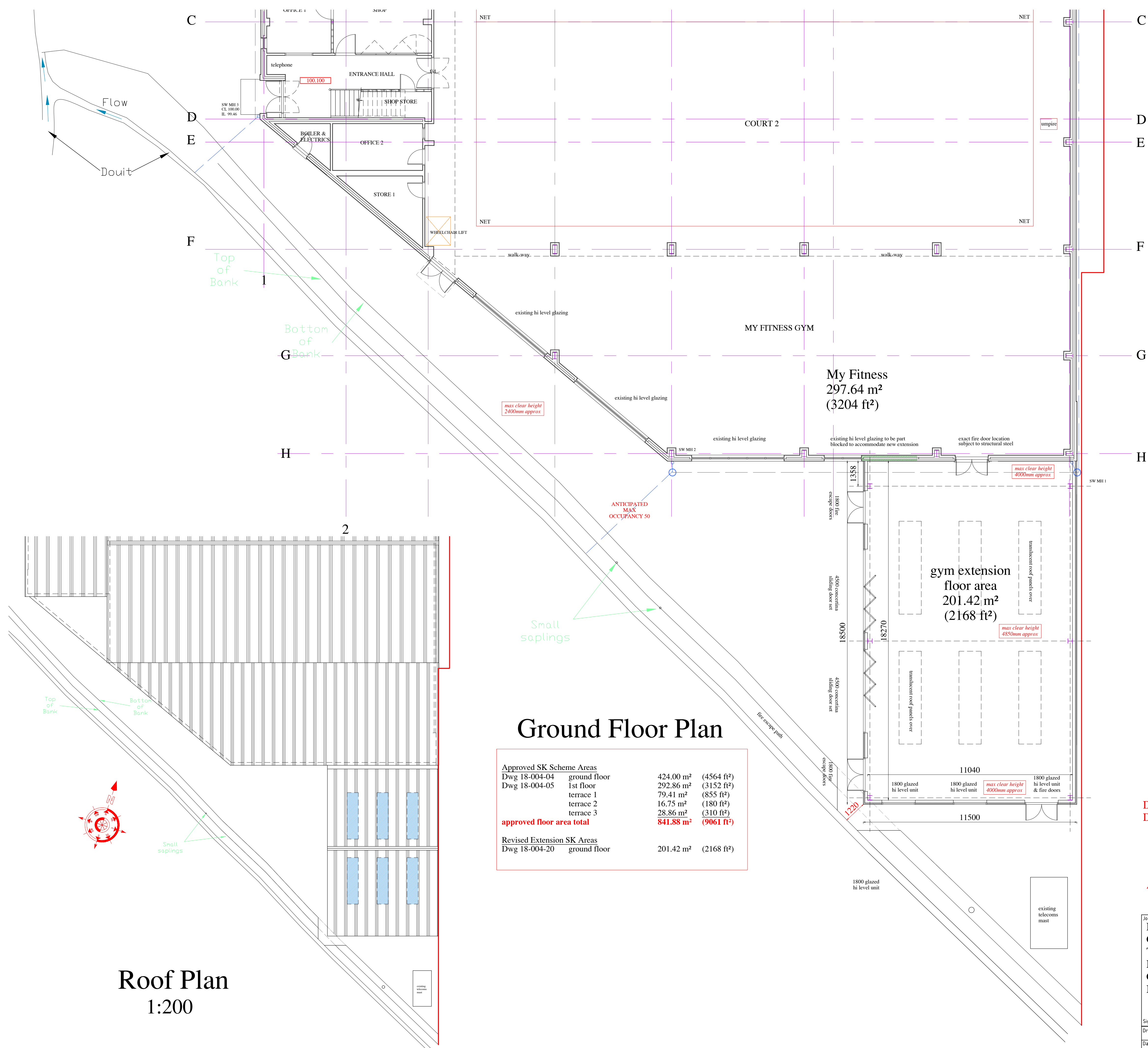
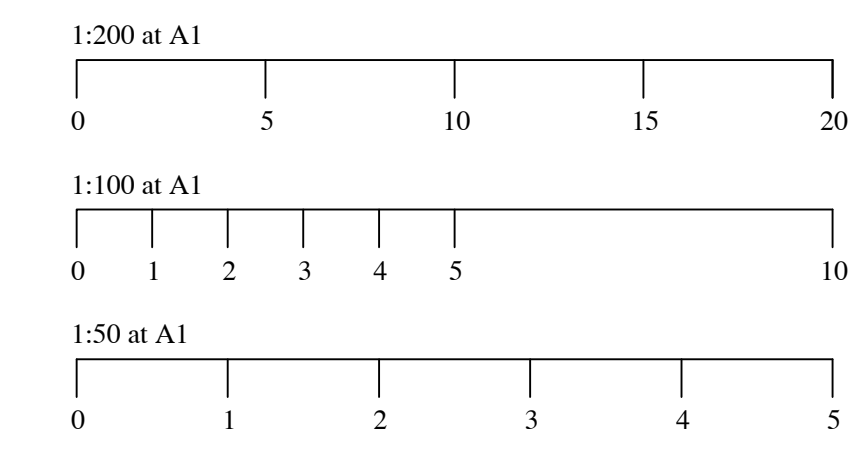
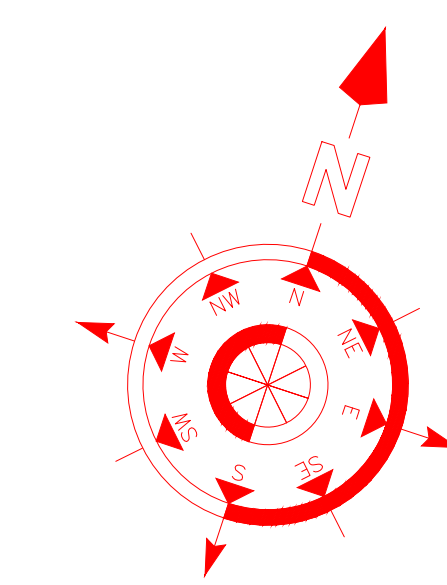

Ground Floor Plan

Approved SK Scheme Areas	
Dwg 18-004-04	ground floor 424.00 m ² (4564 ft ²)
Dwg 18-004-05	1st floor 292.86 m ² (3152 ft ²)
	terrace 1 79.41 m ² (855 ft ²)
	terrace 2 16.75 m ² (180 ft ²)
	terrace 3 28.86 m ² (310 ft ²)
	approved floor area total 841.88 m² (9061 ft²)
Revised Extension SK Areas	
Dwg 18-004-20	ground floor 201.42 m ² (2168 ft ²)

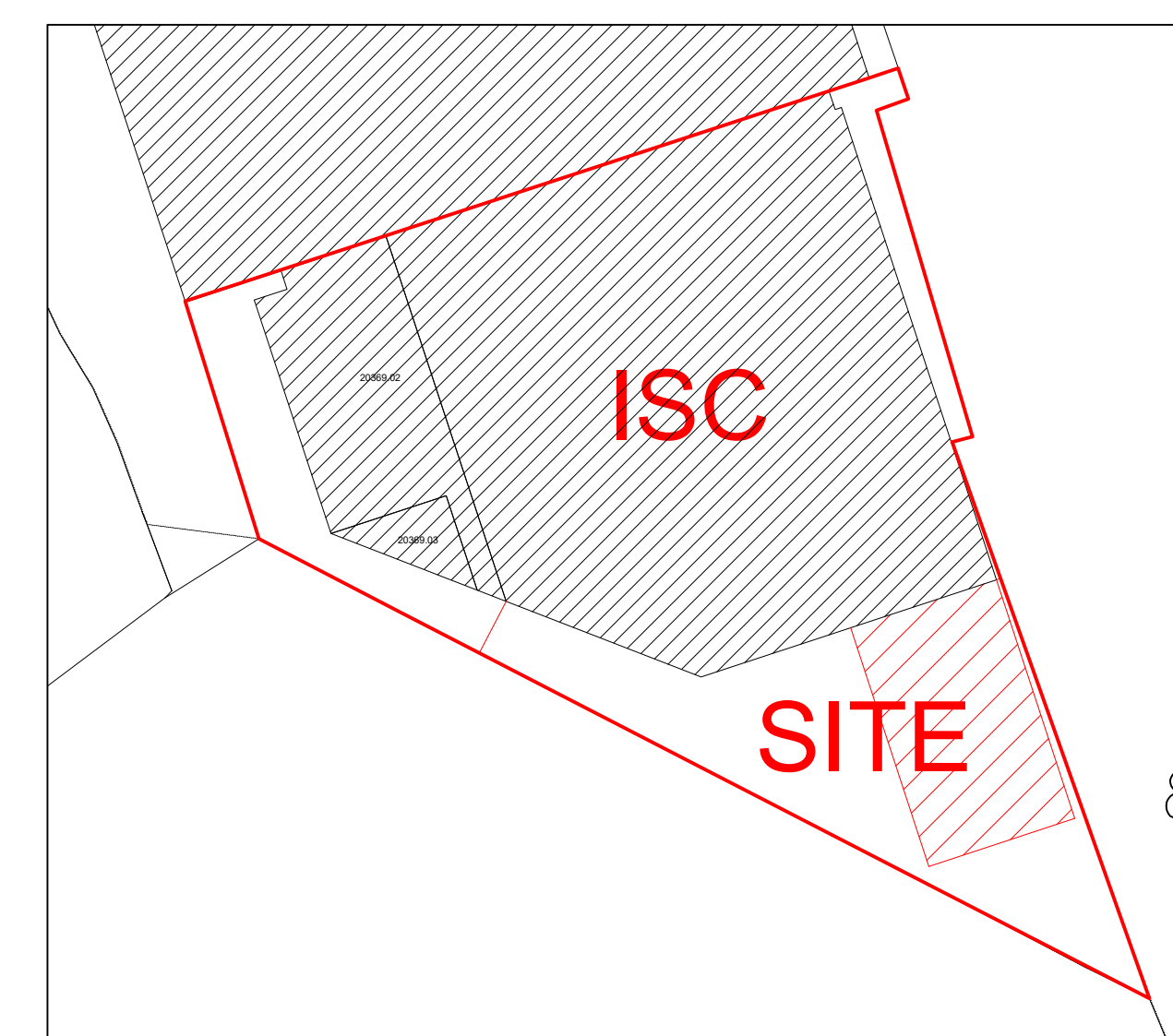

Drawing to be read together with Dwg No 18-004-21

AS AT 2-7-20

Roof Plan 1:200

Job Title Proposed Extension for additional Gym facilities at The Indoor Sports Centre Hougue du Pommier Castel for Indoor Sports Centre Ltd		 Paul Vaudin & Associates Ltd. Architectural Services Sefeld, Rue de la Mare, Castel, Guernsey, GY5 7AT Telephone (01481) 254936 Fax No (01481) 252080 E-mail paul@pvaltd.gg Website www.pvaltd.gg
Drawing Sketch Scheme Ground Floor & Roof Plan		
Signed _____	Date _____	18 - 004 - 22A
Drawn Paul Vaudin	Scale 1:100 at A1	
Date July 2020	Checked _____	