

THIS DRAWING IS COPYRIGHT

This document and its design content is copyright ©. It shall be read in conjunction with all other associated project information including models, specifications, schedules and related consultants documents. Do not scale from documents. All dimensions to be checked on site. Immediately report any discrepancies, errors or omissions on this document to the Originator. If in doubt ASK.

100mm at original scale

ASBESTOS CONTAINING MATERIALS
Due to age and type of building Asbestos Containing Materials may be present. Contractor to undertake R & D Asbestos survey in areas to have works undertaken to ascertain risk

THIRD PARTY RIGHTS & PRIVILEGES
Where proposed alterations to existing buildings, and all works adjacent to existing boundaries/drainage are to be carried out, the legal rights & privileges of all Third Parties are to be considered, with agreements obtained in writing prior to the commencement of work on site.

THE CONTRACTOR & HIS SUB-CONTRACTORS ARE TO VERIFY ALL DIMENSIONS ON SITE BEFORE MAKING SHOP DRAWINGS OR COMMENCING MANUFACTURE

SETTING OUT OF BUILDING WORKS
Figured dimensions to be used in preference to scaled dimensions. Structural grid/overall layout to be set out on site 100% prior to the commencement of building operations.

In addition to the hazard/risks normally associated with the types of work detailed on this drawing take note of the above. It is assumed that all works on this drawing will be carried out by a competent contractor working, where appropriate, to an appropriate method statement.

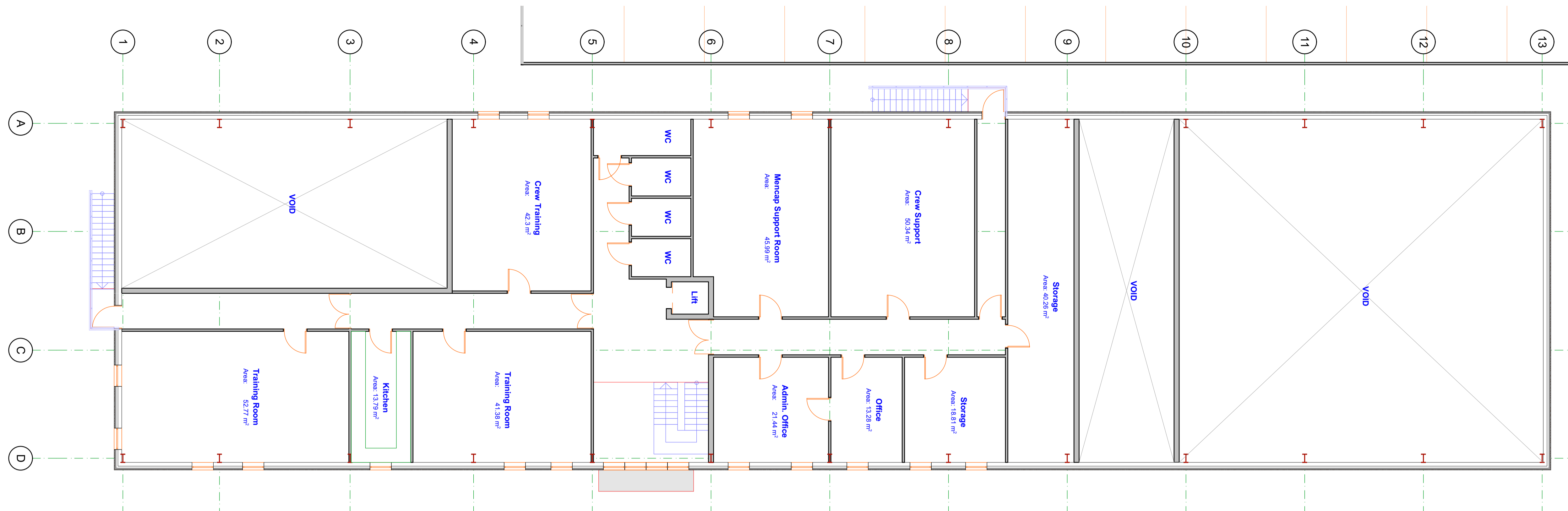

First Floor Plan

1:100

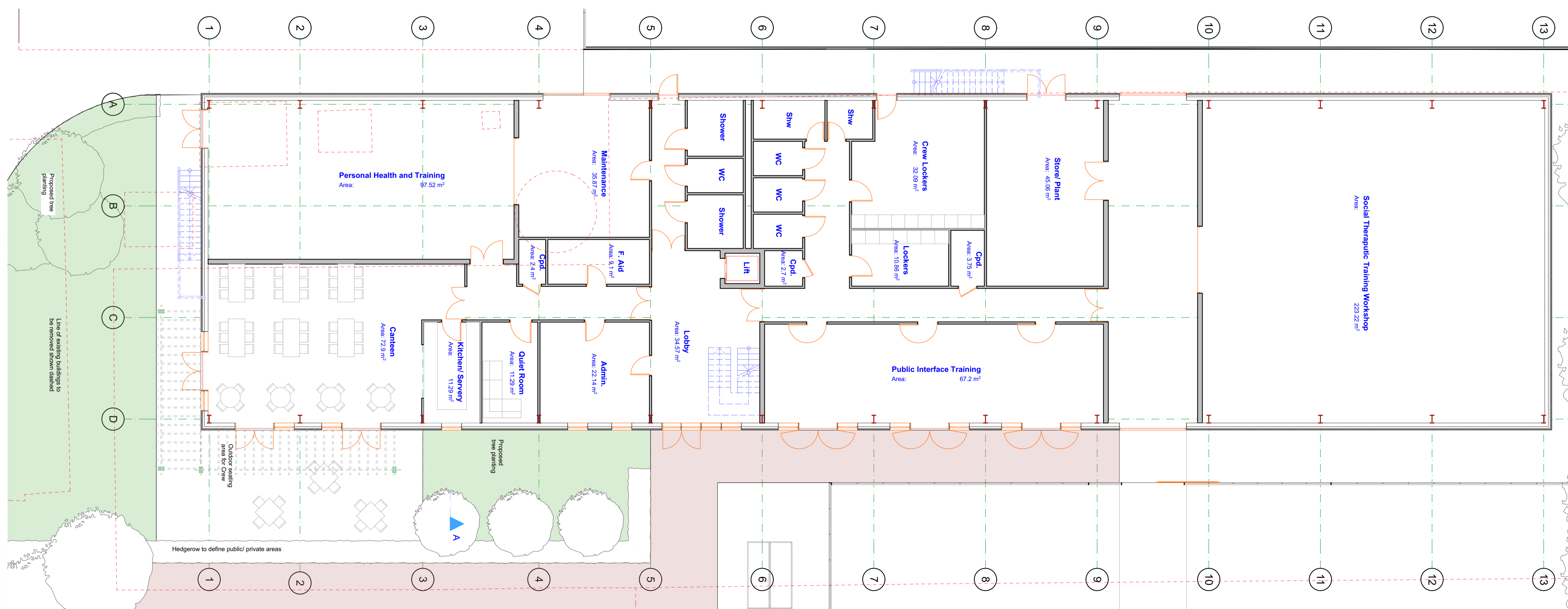

Ground Floor Plan

1:100

Purpose of Issue
PLANNING DRAWINGS

Work Stage
03



Grey Bear Ltd.
No 3 Northumberland House, La Rochelle Road, Vaux, Guernsey GY3 5DP
T: 07911 766 731
enquiries@greybear.co.uk
www.greybear.co.uk

Project
Grow Ltd. Replacement Glasshouses & Crew Facilities
Petits Quartiers Vinery, Coutanchez, St Sampson

Client
Grow Ltd.

Layout Title
Crew Facilities- Floor Plans

Drawn by
ELC

Drawing Number
056-3-003

Revision