

Upper Ground Floor Plan 1:50 @ A1

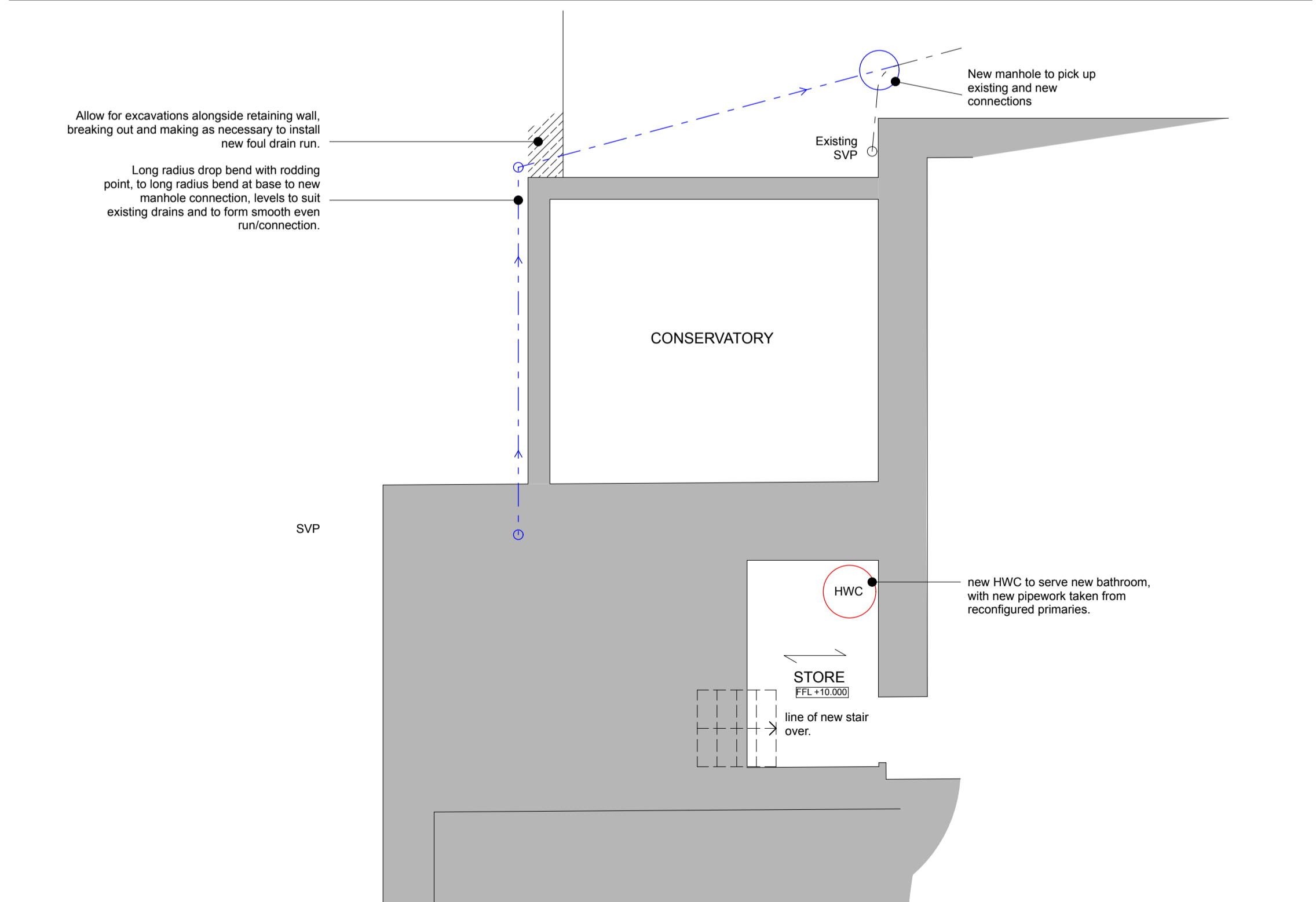

Lower Ground Floor Plan 1:50 @ A1

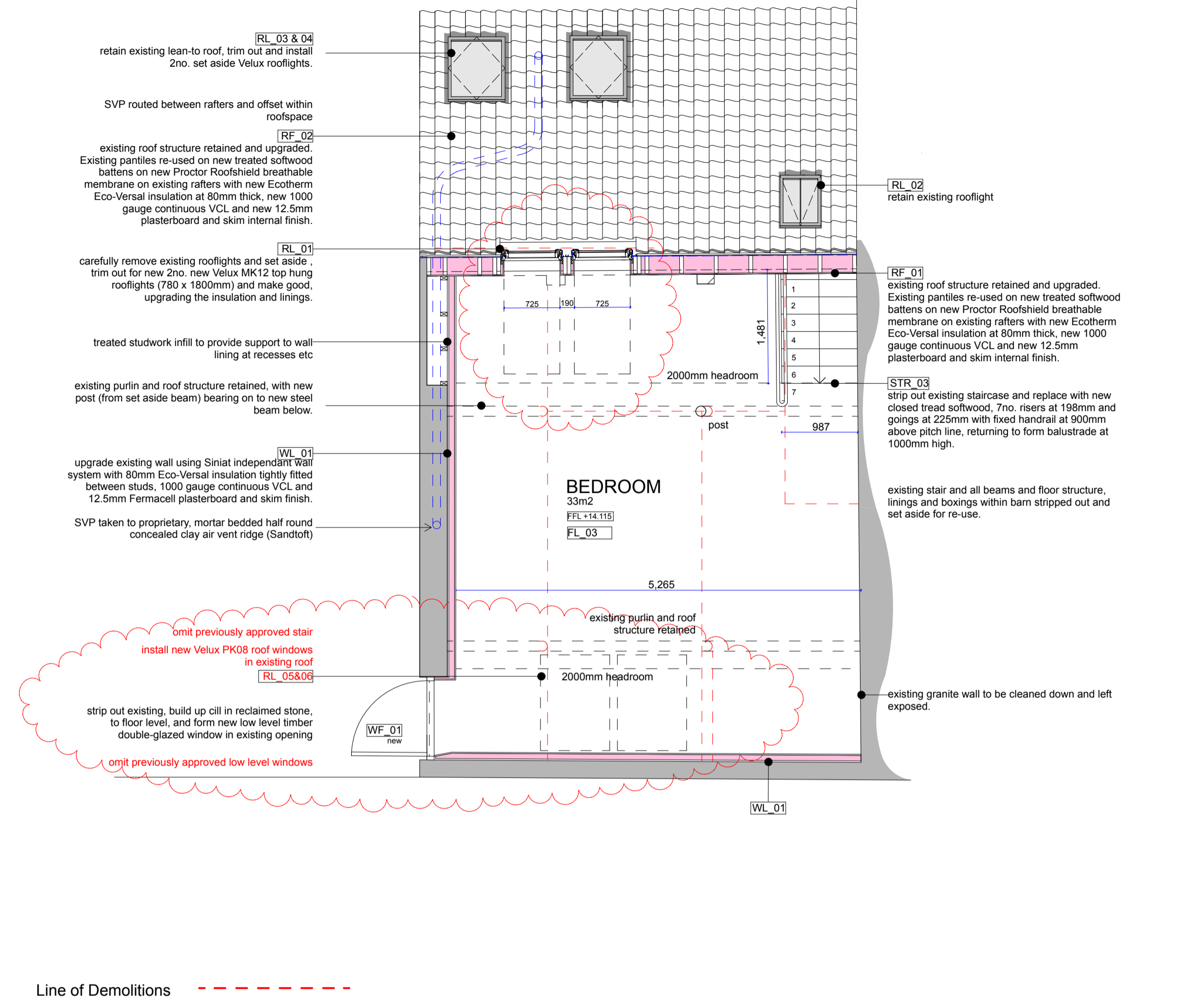

First Floor Plan 1:50 @ A1

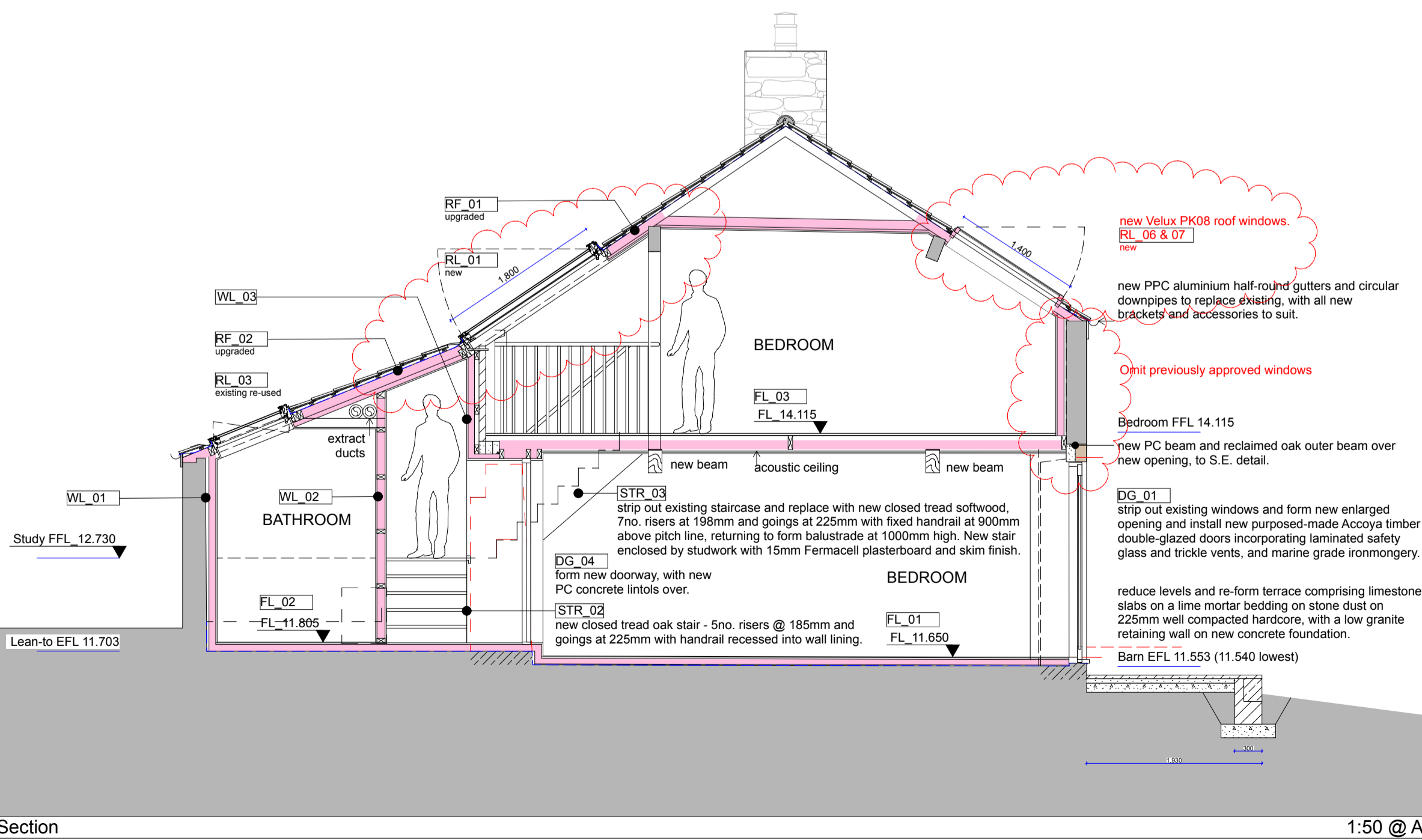

Section 1:50 @ A1

Copyright:
This drawing is the copyright of Les Portes Ltd and may not be reproduced without their permission in writing.
Note:
It is the contractors responsibility to check all dimensions and levels on site and report all discrepancies immediately to the architect.
The contractor should not scale off the drawings under any circumstance.

Revisions

rev.	description	date
A	Omitted glazing and added new Velux rooflights to South Elevation, adjusting DG_01 height. Omit external stair and reduce height of WF_01. Retain existing boiler and oil tank and move externally, with new blast wall and boiler housing.	06/08/20

SimonCottell
chartered architect 肆

www.simoncottell.com • studio@simoncottell.com • 07781 433703 •

Project
Alterations to
Allons-Y
Courtill Ronchin
St. Andrew
Guernsey GY6 8YW

Client
Mr T. and Mrs C. Andrews

Drawing title
Ground Floor Plan

Status CONTRACT

Date August 2020	Scale 1:50
Project no. 352	Drawing no. C_04.02_A