

**KEY**

- 1. HALL
- 2. BOOT ROOM
- 3. COOKING
- 4. DINING
- 5. SHOWER ROOM
- 6. SITTING
- 7. TV ROOM
- 8. LAUNDRY
- 9. STUDY
- 10. WARDROBE
- 11. BATHROOM
- 12. BEDROOM
- 13. GARAGE
- 14. PARKING
- 15. PATIO

**LEGEND**

EXISTING

PROPOSED

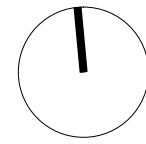

**MATERIALS LEGEND**

- A. STONE PAINTED
- B. TIMBER FRAMED GLAZED WINDOWS.
- C. SLATE CLADDING OVER TIMBER FRAME.
- D. TIMBER DOOR/TIMBER PANELING

**NOTES**

All survey information shown on drawings is taken from various sources. Please check all dimensions prior to construction.

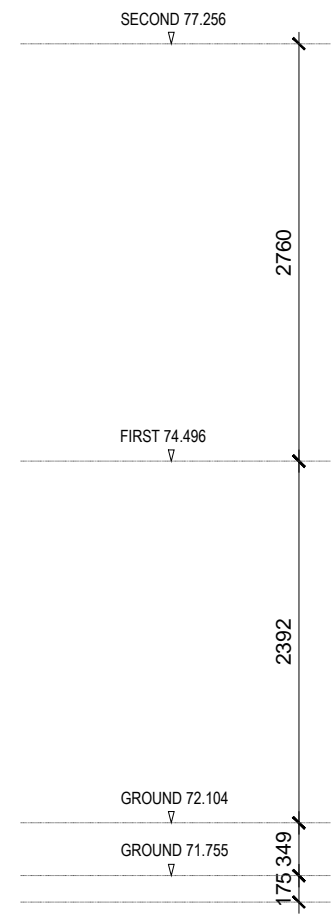

**SECTION 22**  
1:50

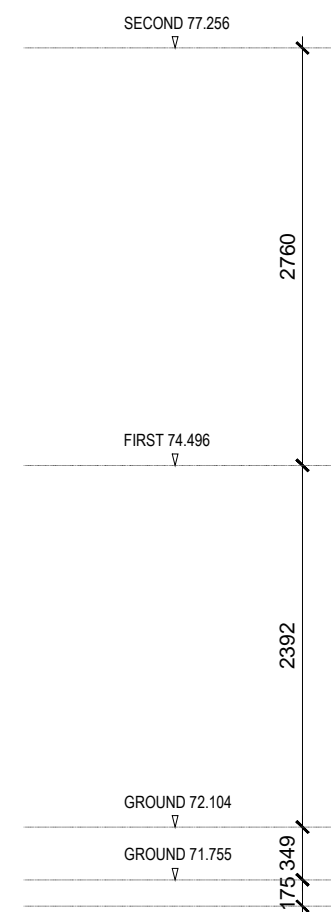

**EAST ELEVATION (REAR)**  
1:50

THIS DRAWING IS NOT TO BE SCALED / DIMENSIONS TO BE CHECKED ON SITE / © JAMIE FALLA ARCHITECTURE

REVISION	DATE	DESCRIPTION	REVISION	DATE	DESCRIPTION

**JAMIE FALLA ARCHITECTURE**  
29 MILL STREET  
ST PETER PORT  
GUERNSEY  
GY1 1HQ  
T 01481 728856 W jamiefallaarchitecture.com E studio@jamiefalla.com

PROJECT: SAUMAREZ HOUSE	SITE ADDRESS: QUEENS ROAD, ST PETER PORT	
TITLE: SURVEY - SECTION 22 & EAST ELEVATION	DATE: JAN 2020	DRAWN: DH
SCALE: 1:50 AT A1 ORIGINAL	APPROVED: JF	<b>948-SVY-21</b>