



DHS

Longcamps, St Sampsons  
Guernsey GY1 3FD

Tel: 01481 725460  
Fax: 01480 713618

**INSTALLATION DRAWING SCHEDULE**

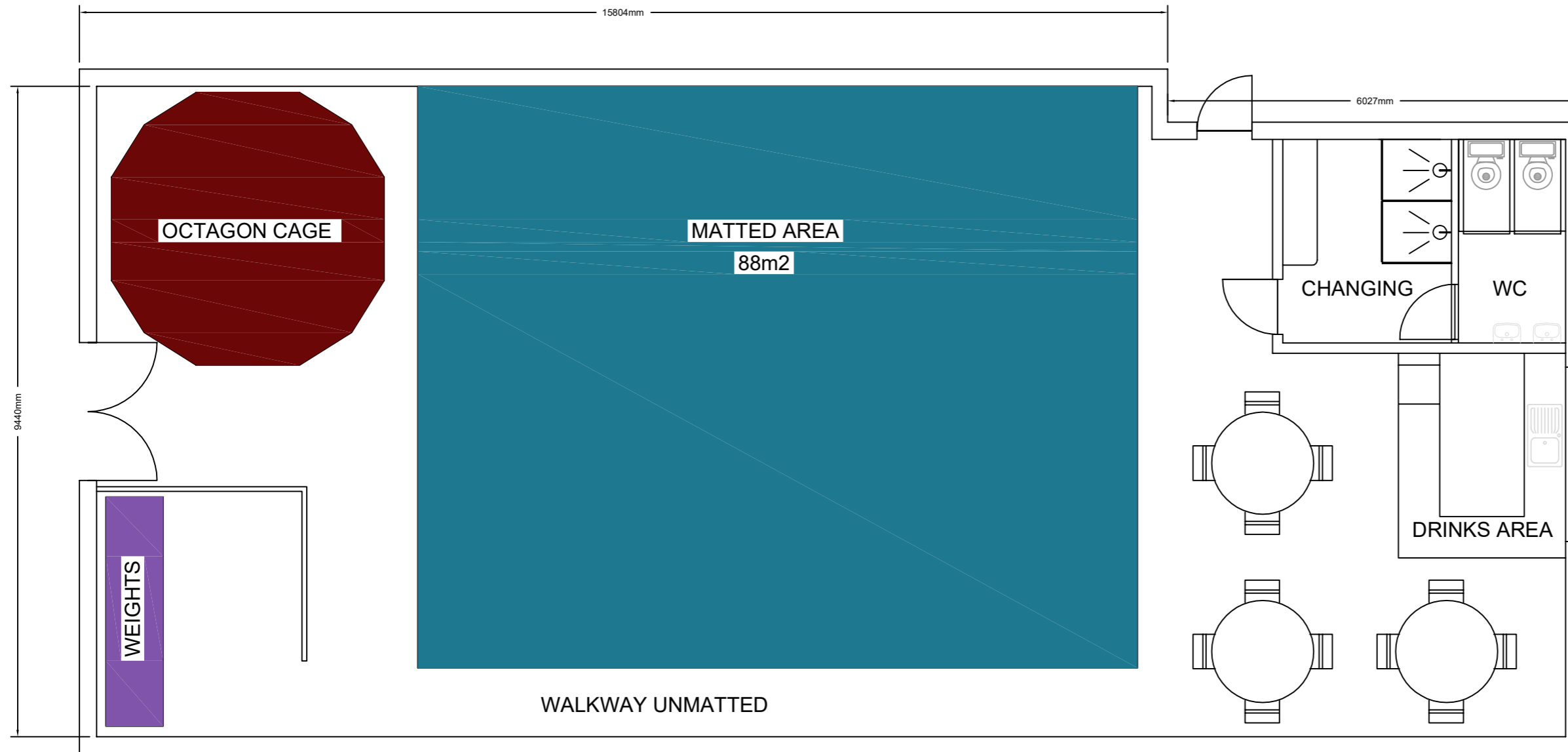

**GENERAL NOTES**

- 1: All flows and returns are in 15mm unless otherwise specified. The pipework layout on the drawing is for indication only. All pipework should be laid in accordance with the Building Regulations.
- 2: On the information provided an approximate joist/batten layout has been drawn in order to provide guidance for the positioning of the panels only. Refer to Architects drawings/instructions for actual joist/batten positions and layout.
- 3: On joisted or battened floors the ends of panels must be supported by the joists or the battens or appropriate cross batten supports (noggin/dwangs)
- 4: Insulate between all joists/battens.
- 5: Please refer to the Installation Guide for further information, your attention is drawn in particular to the sections on pressure testing, commissioning and balancing the circuits.

**#WARNING#**

Certain anti-dusting agents used on screeds are not compatible with insulation products and plastic piping. Please check chemical compatibility before applying.

**UNDERLAYS**

Care must be taken when selecting underlays, do not select underlays that have good insulation properties such as felt or high-density rubber crumb, as these will severely impede heat transference.

X	
X	
PROJECT No: 16-2020/C	
REVISION:	PREVIOUS REVISIONS: X
DRAWING:	X
DRAWN BY: X	X
DATE: 28/07/20	X
SCALE:	X



**DHS Ltd Longcamps, St Sampsons -Tel:01481-725460 Email:design@dhs.gg Web: dhs.gg**

**\*\*Please note that the design is a layout guide only and is not to scale\*\***

