

REVISION

| REV. | DATE | DESCRIPTION | SIG. |
|------|------|-------------|------|
| | | | |
| | | | |

1603.01

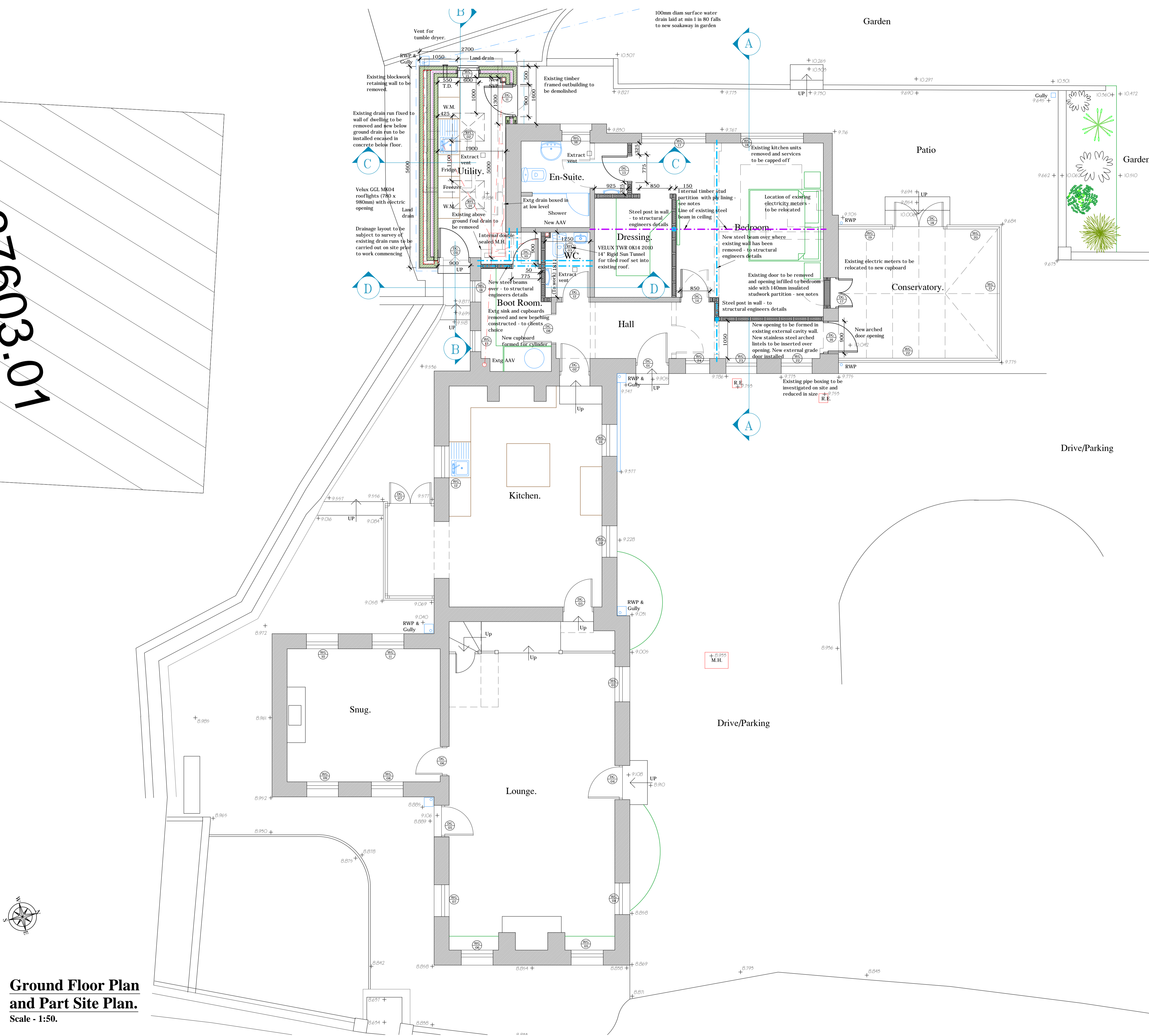

This drawing is to be read in-conjunction with drawing No's: 1412-WD-01, 03, 04, 05, 06, 07 & 08.

| | | |
|---|---|-------------------------------|
| DIRECT ARCHITECTURAL SOLUTIONS | | |
| CHARTERED SURVEYOR · ARCHITECTURAL TECHNOLOGIST · PROJECT MANAGEMENT | | |
| BRISE DE MAIR, RUE DU GAINS, TEL · OFFICE +44 (0)1481 266311. TORTEVAL, GUERNSEY, GY8 DPJ. FAXSIMILE +44 (0)1481 266322. | | |
| PROJECT | Extension and Alterations to 'Forest Lodge', Les Ruettes, St Andrews, Guernsey, GY6 8UG. | |
| CLIENT | Mr. & Mrs. D. Meeks. | |
| DRAWING | Working Drawing - Ground Floor Plan | |
| SCALE | 1:50. | DRAWN <i>Carl and J.B.</i> |
| | | DATE 16th December 2020. |
| DRAWING NO. | 1412-WD-02. | REVISION |

Ground Floor Plan and Part Site Plan.
Scale - 1:50.